

# RodKat

## Instruction Manual



# Table of Contents

Installation Instructions: RodKat Universal Shower Trays & Sloped Wedges.....	3
Installation Instructions: RodKat Drain Base.....	4
Photo Guide for RodKat Drain Base - A.....	5
Photo Guide for RodKat Drain Base - B.....	6
Photo Guide for RodKat Drain Base - C.....	7
Photo Guide for RodKat Drain Base - D.....	8

## Installation Instructions:

### RodKat Universal Shower Trays and Sloped Wedges

The substrate below the RodKat Universal Shower Tray or Sloped Wedge must be level, clean and load bearing to current industry standards and applicable building codes.

Your RodKat product can be installed before or after the wall substrate is installed.

- Dry fit the RodKat product to ensure proper fit and orientation.
- Apply any industry approved thin-set mortar to the substrate using a 3/8" x 3/8" (10 mm x 10mm) square or U-notched trowel. Key thin-set onto the back of the shower tray/sloped wedge using the flat side of the trowel to assure 100% coverage.
- Place the RodKat product down and embed the tray/sloped wedge solidly into the mortar.

**Note:** Walking on the surface will embed the shower tray or sloped wedge.

When there is plumbing access from below, the drain and drainpipe can be prepared and installed after the installation of the shower tray/sloped wedge.

When there is no plumbing access from below, the drain is measured and dry fitted before the installation of the RodKat Universal Shower Tray/Sloped Wedge. The drain is then installed to the appropriate height and connected to the waste line after installation of the tray.

Next, install your appropriate drain base (see pg. 4 and photo guides).

#### **IMPORTANT:**

- RodKat shower components **ARE NOT WATERPROOF** nor are they wear surfaces.
- All exposed areas must be waterproofed following manufacturers' waterproofing instructions, ANSI specifications, industry standards, and by applicable building codes for the finish selected by the user.

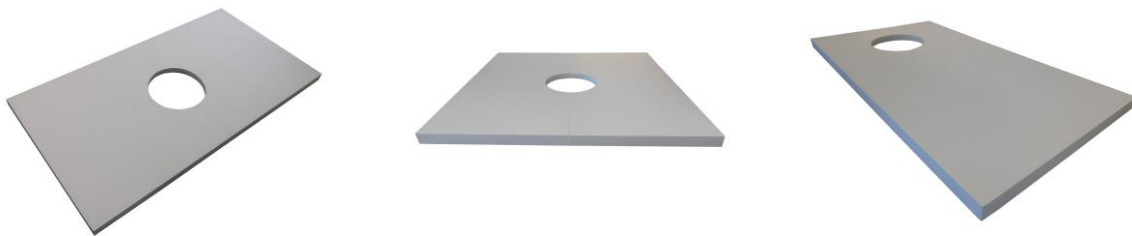

## Installation Instructions:

### RodKat Drain Base

When you order a RodKat Universal Shower Tray, you will also be provided a RodKat Drain Base, depending on the drain you are using. This drain base is a foam piece you will need in order to properly install your drain.

Just like your shower tray, this foam piece needs to follow the same installation guidelines as explained on page 3.

- Install the RodKat Drain Base by applying thin-set mortar to the sides and bottom of the drain base. Set the drain base into the hole of the Universal Shower Tray and apply pressure.
- Thin set the top of the foam drain base and then press your drain into the mortar to fully embed it into the shower tray.
- The drain must sit flush or slightly below the shower tray surface.

At this point, the entire shower tray, including the drain, **must be waterproofed** following manufacturers' waterproofing instructions, ANSI specifications, industry standards, and by applicable building codes for the finish selected by the user.

**Note:** There are four different types of RodKat Drain Bases. Each type is compatible with certain drains. See photo guides on the following pages for more drain information.



Drain Base A



Drain Base B

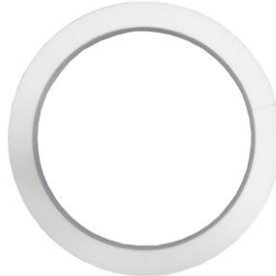

Drain Base C



Drain Base D

## Drain Base A – Schluter Kerdi Drain A (Adaptor Kit) Installation Photo Guide

**Note:** This guide does not demonstrate the thin-set and waterproofing processes.

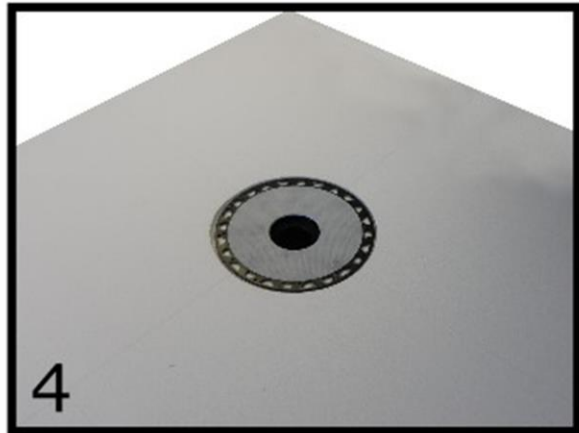
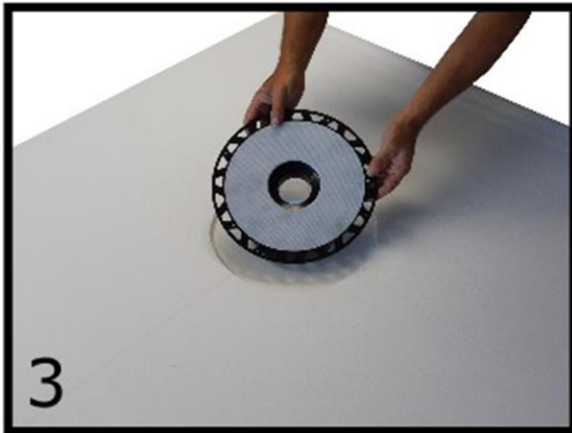
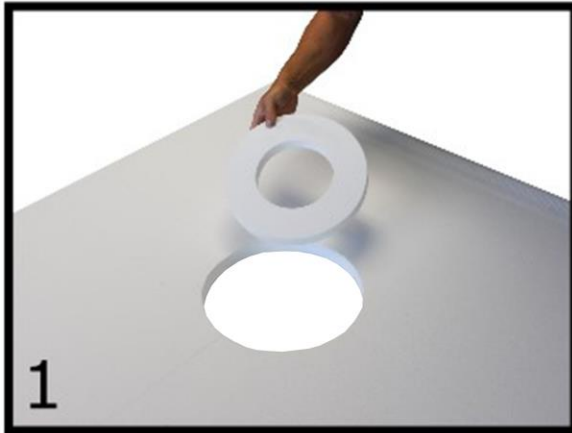

# Drain Base B - Ebbe Versa Installation Photo Guide

**Note:** This guide does not demonstrate the thin-set and waterproofing processes.

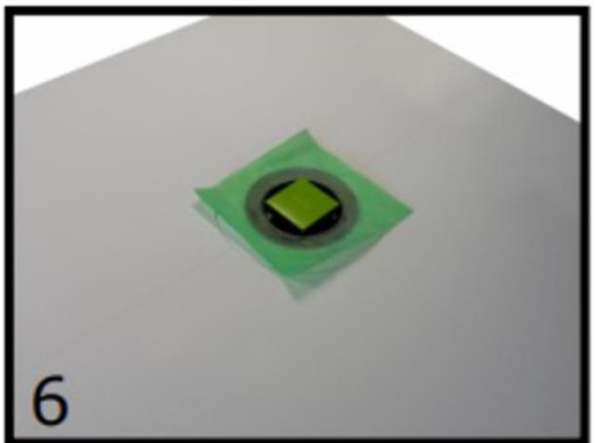
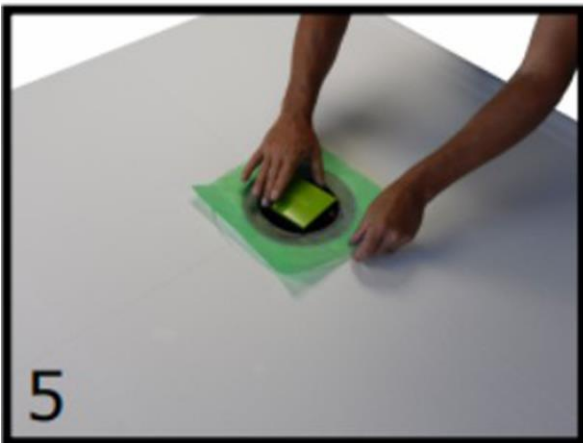
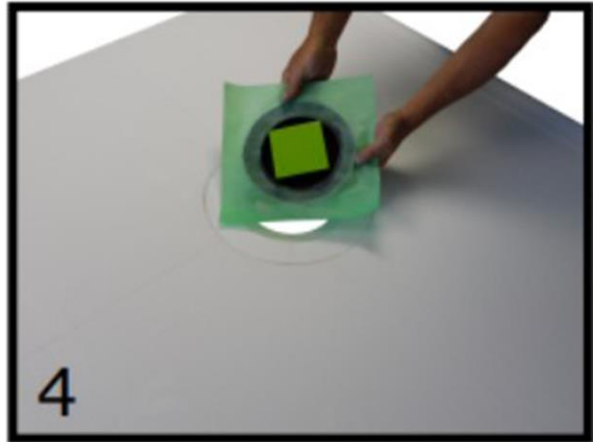
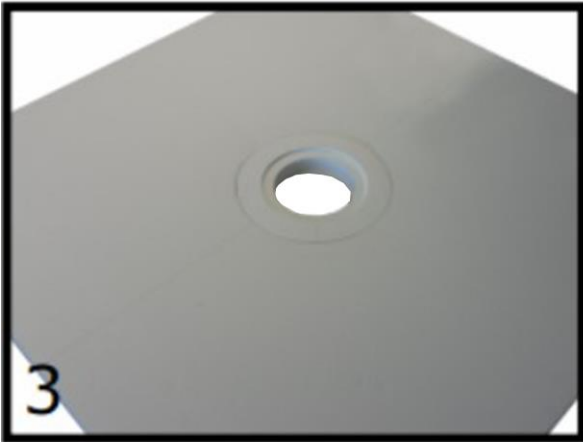
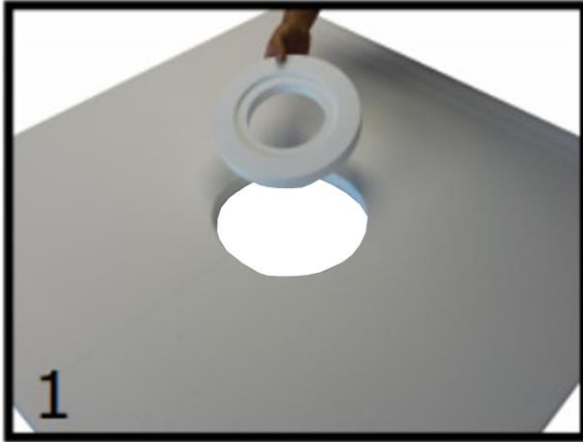

# Drain Base C – NobleFlex Drain Flashing & Schluter Kerdi Drain Flashing Installation Photo Guide

**Note:** This guide does not demonstrate the thin-set and waterproofing processes.

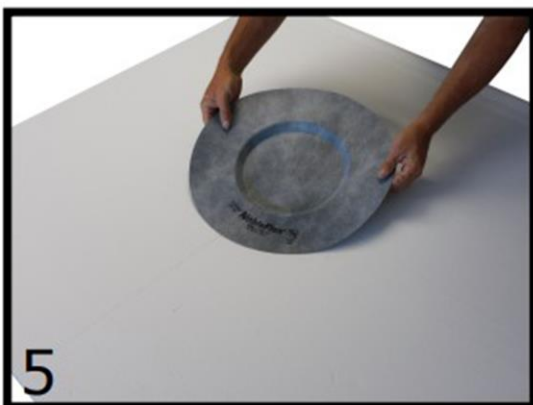
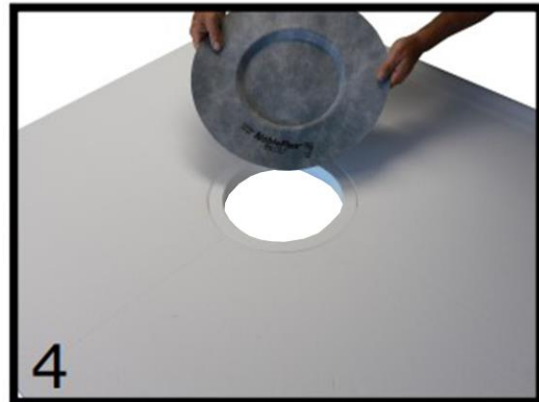
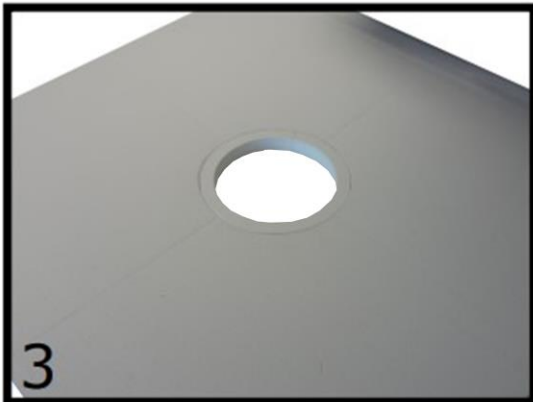
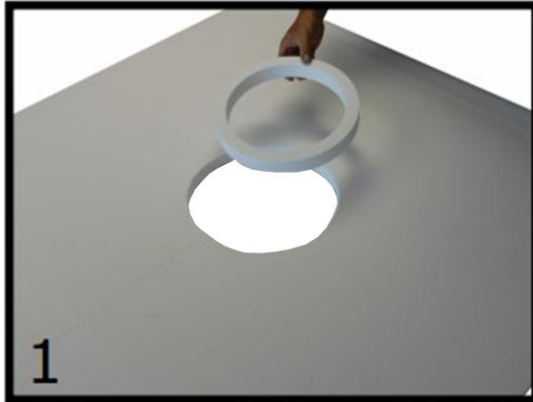

# Drain Base D – USG, FloFX, Schluter Kerdi Drain, Profilitec & Laticrete Installation Photo Guide

**Note:** This guide does not demonstrate the thin-set and waterproofing processes.

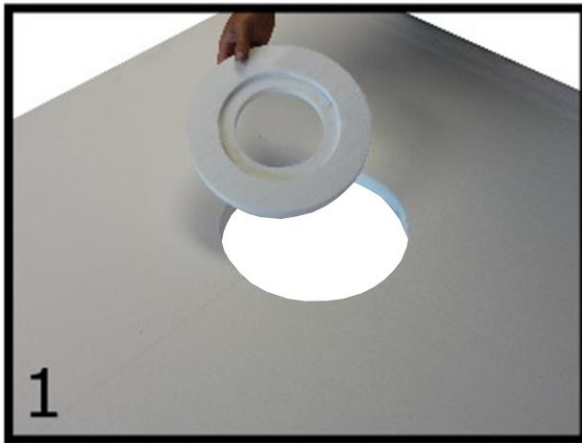

\*\*Drain pictured is FloFX Drain