

THE NEW NORMAL

ARC<sub>inc.</sub>



ARC  
CURBLESS  
SHOWERS

DESIGNED AND BUILT ON A

**TrueDEK<sup>TM</sup>**

SHOWER FOUNDATION

# ARC CURBLESS SHOWERS USING TRUEDEK FOUNDATIONS

- The nation's leading curbless shower system
- Structural base + drain + waterproofing system

## TrueDEK™ Installation Steps

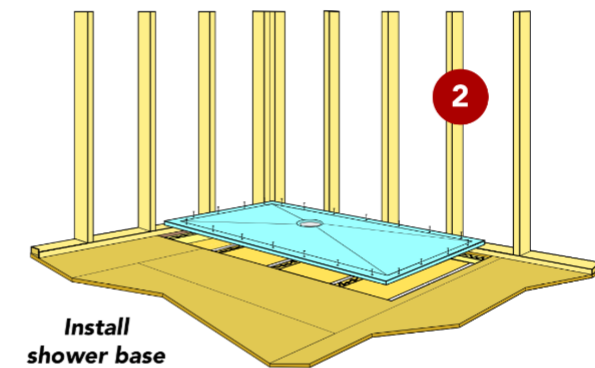
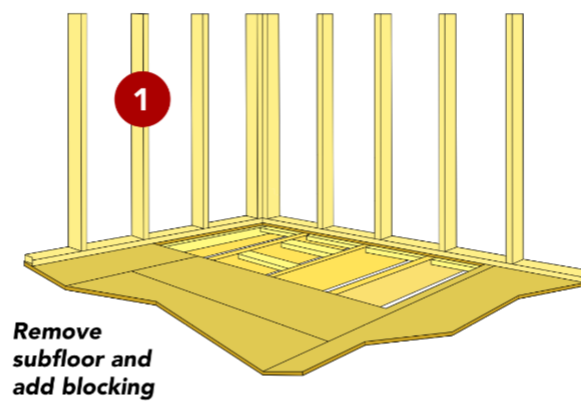

**STRUCTURAL & PRE-PITCHED**

Go to [www.arcfirst.net](http://www.arcfirst.net) for detailed, step-by-step installation instructions

**LEVEL ENTRY**

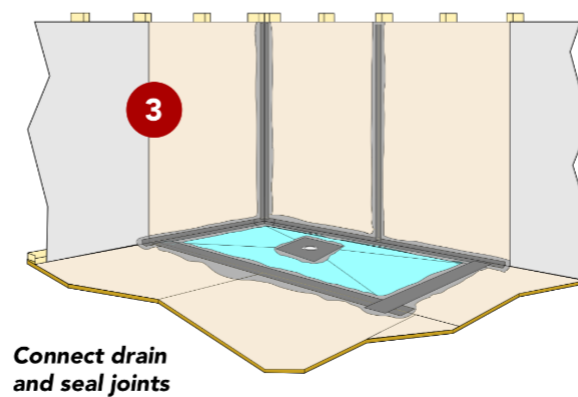

**READY FOR TILE OR STONE**

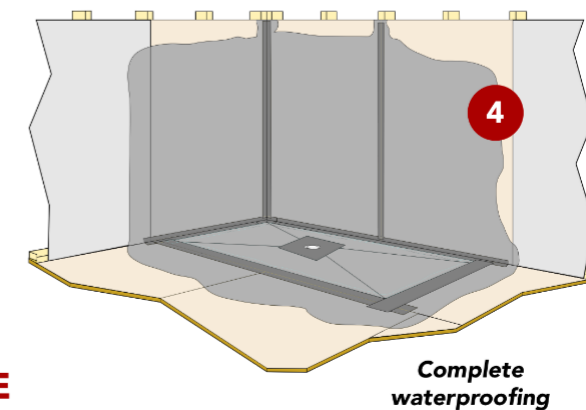

CURBLESS  
SHOWER  
DESIGN IS THE  
'NEW NORMAL'



# WHO IS CHOOSING TO GO CURBLESS?

- People from all ages are choosing to go curbless
- America and Canada are among the last countries to still install curbs in residential shower applications



# CURBLESS SHOWERS FROM HOUZZ

- All Houzz curbless showers promote design over functionality but in reality, both are on display.



# WHY GO CURBLESS?

- Provides a very stylish, clean & sleek look
- Makes your bathroom look and feel 20%-30% larger
- Much easier to clean
- Achieves a Future proof bathroom



# WHAT IS A FUTURE PROOF BATHROOM?

- Shower is curbless
- Plywood backing throughout entire shower area walls
- Waterproof entire wall system and floor area



# WHY DO I NEED TO FUTURE PROOF MY BATHROOM?

- Every bathroom should be future proofed
- "We cannot predict the future but we can design for it"
- If any additional costs are incurred when achieving a future proof bathroom, those costs should be considered an insurance policy as to not have to spend thousands of dollars down the road if an unexpected situation requires removal of the curb.





# WHAT WAS THE PURPOSE OF A CURB IN A SHOWER?

- The curb is designed to do 2 things
- 1) Allows pitch to be created within the shower to get water to the drain.
- 2) Keeps water within the shower area. This is needed because the actual shower base, including the drain, is **HIGHER** than the rest of the bathroom floor so any water that gets out - stays out.



# CURBLESS

- True curbless showers that are done correctly always have the drain set as the **LOWEST** part of the bathroom floor
- Because the ARC TrueDek foundations are pre-pitched & structural, the drain becomes the lowest point of the floor without having to modify the structure-ability of your floor assembly.



# HOW DO YOU KEEP WATER WITHIN THE SHOWER IF YOU DON'T HAVE A CURB?

- Because the pitch always starts from the highest part of the floor and flows down to the drain which is the lowest part of the floor, 99% of the water goes down the drain.
- A little overspray is of no concern because your bathroom floor is also waterproof.
- No shower door needed as long as there is a sufficient heat source.

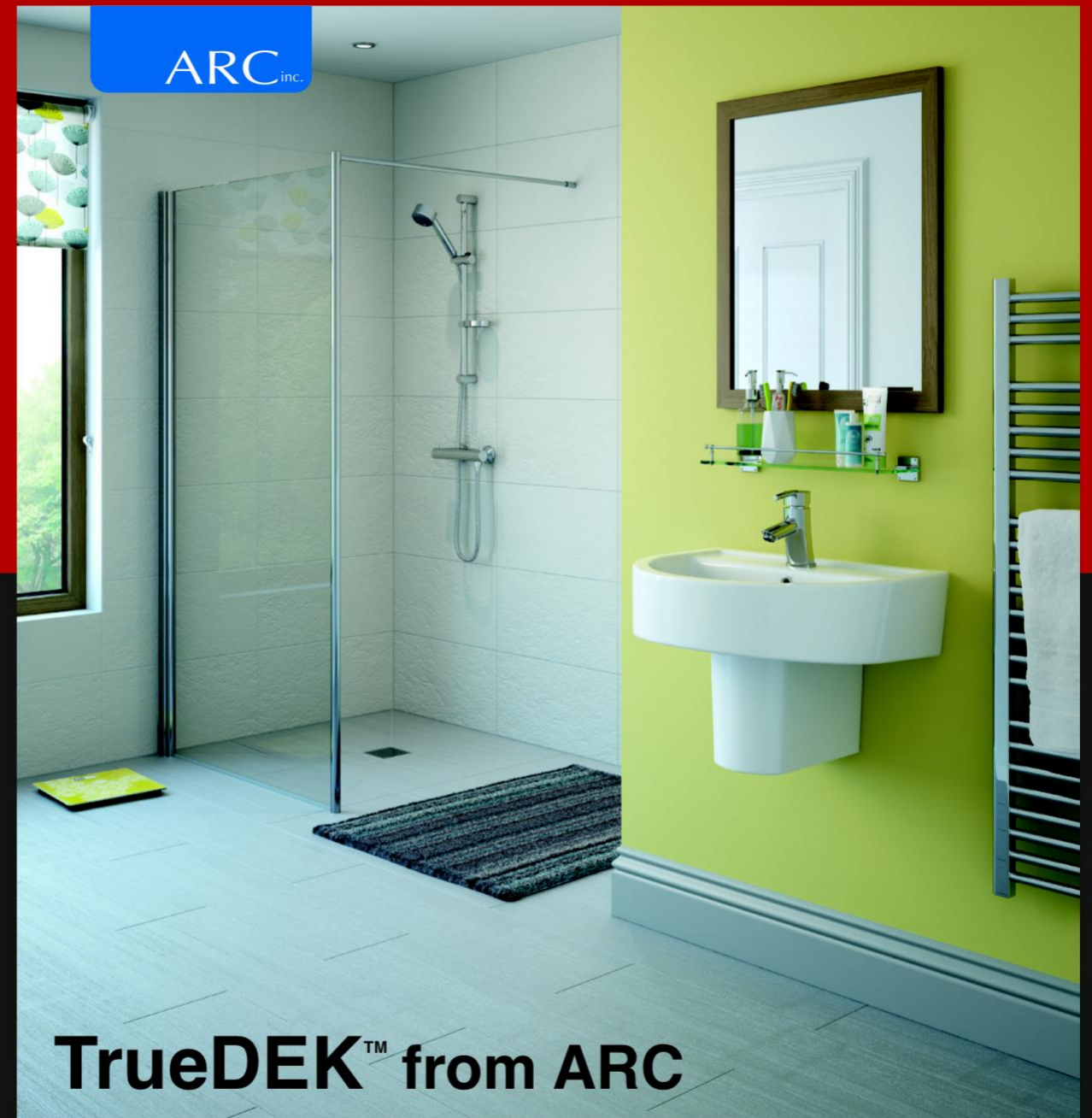

*ARC's TrueDEK pre-pitched foundations provide the structural backbone of today's exceptional level-entry shower designs.*

ARC TRUEDEK SHOWER FOUNDATIONS  
THE BEST WAY TO ACHIEVE  
'CURBLESS'



# 4 EASY INSTALLATION STEPS

- Cut out subfloor
- Install base
- Reinforce critical joints with tape
- Waterproof entire shower

# curbless



# DESIGN

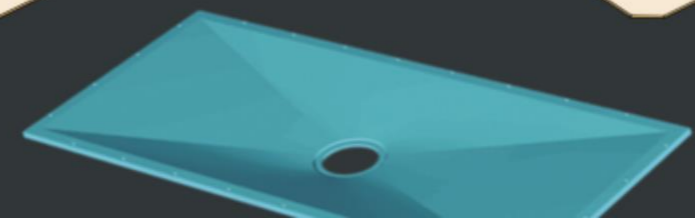
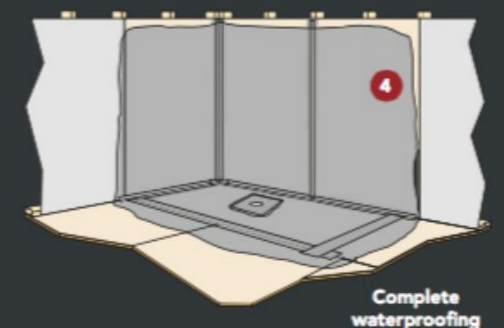
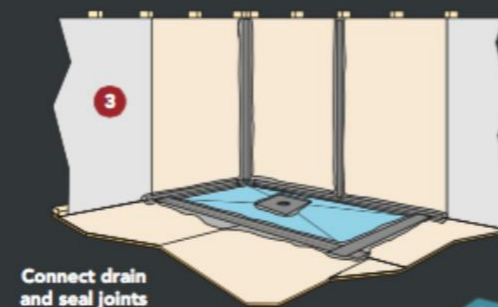
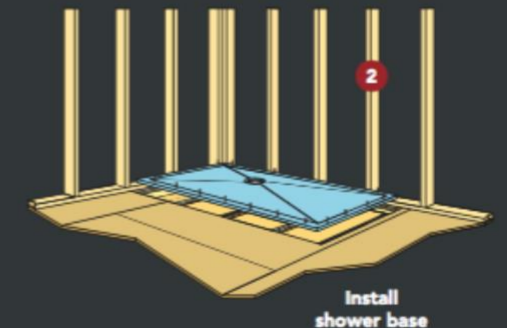
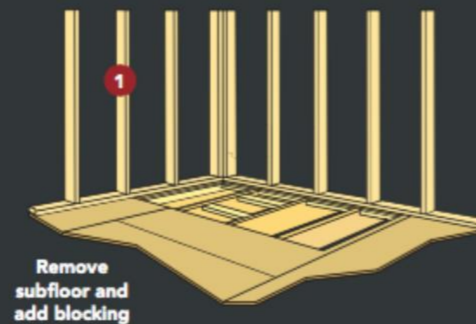

ACTUAL STEP BY  
STEP  
INSTALLATION  
OF TRUEDEK  
SYSTEM



REMOVE SUBFLOOR



ADD BLOCKING TO SUPPORT  
PAN





INSTALL PAN



WATERPROOF ENTIRE  
SHOWER



# TILE SHOWER



# ARC TRUEDEK BASES

- Contain a lifetime warranty
- Tile can be removed from the base down the road without damaging the base or affecting the warranty as long as it's done within the ARC guidelines
- The base becomes a fixture in your home



*go*

**CURBLESS**

DESIGN  
WITHOUT  
BARRIERS

ARC<sup>inc.</sup>

*ask us how*