

- Plumbing Code Approved
- Seven drain lengths
- Five 316 stainless steel strainer designs
- ADA-compliant strainer options
- Ideal for use in barrier-free showers
- High capacity 36 GPM drainage
- Available in seamless PVC and ABS construction
- One-piece base construction with low profile
- Most secure watertight connection
- Flat bottom with internal slope to drain – no shimming or leveling needed
- No substrate modification required
- Off-set outlet designed for standard floor joists
- Install at thresholds or exits for overflow control
- Removable internal pre-strainer for ease of maintenance
- Drain materials are suitable for outdoor use
- Clamping collar ensures watertight connection
- Waste pipe fastens directly to drain
- Customizable drains for large projects*
- Link multiple drains to span longer areas
- Full Mortar Bed Adapter Kit available

Use FreeStyle Linear Drains with NoblesSeal® TS for the most dependable waterproofing or use with Chloraloy® and the Full Mortar Bed Kit for a traditional full mortar bed method installation.

FREESTYLE LINEAR DRAINS:

- | | |
|--|--|
| <input type="checkbox"/> 24" Drain ABS | <input type="checkbox"/> 24" Drain PVC |
| <input type="checkbox"/> 32" Drain ABS | <input type="checkbox"/> 32" Drain PVC |
| <input type="checkbox"/> 36" Drain ABS | <input type="checkbox"/> 36" Drain PVC |
| <input type="checkbox"/> 40" Drain ABS | <input type="checkbox"/> 40" Drain PVC |
| <input type="checkbox"/> 48" Drain ABS | <input type="checkbox"/> 48" Drain PVC |
| <input type="checkbox"/> 54" Drain ABS | <input type="checkbox"/> 54" Drain PVC |
| <input type="checkbox"/> 60" Drain ABS | <input type="checkbox"/> 60" Drain PVC |

*Custom sizes available with minimum 50 units

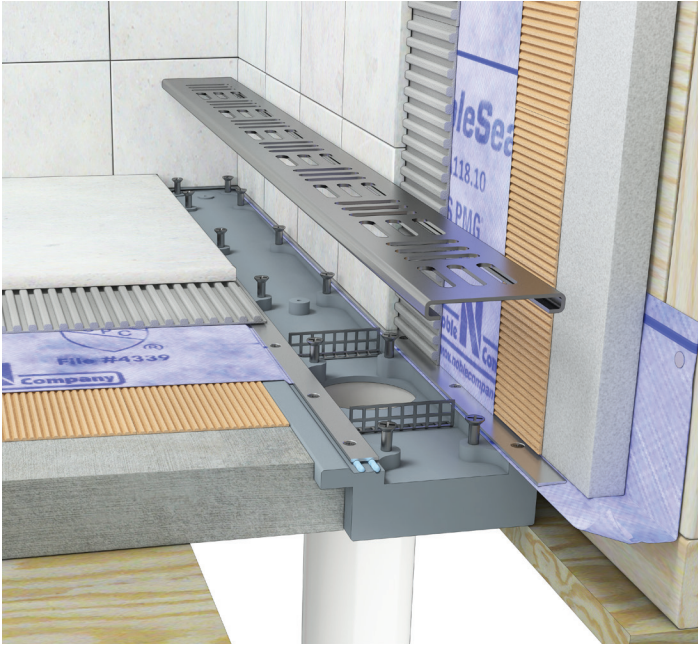

SEE REVERSE FOR DIMENSIONS AND FINISHES

TO BE SPECIFIED:

- Cross-Hatch Strainer
- Slotted Strainer¹
- Wave Strainer
- Tile Top Strainer (Install your tile)¹
- Pyramid Strainer¹

¹Complies with ADA guidelines for handicap accessible showers.

- Full Mortar Bed Adapter Kit
- Strainer Connector Kit

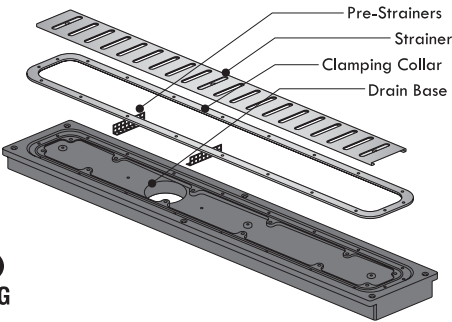

Approved by the State of Massachusetts



		24" Drain	32" Drain	36" Drain	40" Drain	48" Drain	54" Drain	60" Drain
Base Length	A	24"	32"	36"	40"	48"	54"	60"
Strainer Length*	B	21-3/4"	29-3/4"	33-3/4"	37-3/4"	45-3/4"	51-3/4"	57-3/4"
Hole Center	C	15-3/4"	19-1/2"	21-3/4"	23-3/4"	27-3/4"	30-3/4"	33-3/4"
Thickness	D	1-1/4"	1-3/8"	1-3/8"	1-7/16"	1-1/2"	1-9/16"	1-5/8"

*Deduct 3/8" from length for Tile Top Strainers, width of strainer to for Tile Top (below) is 2"

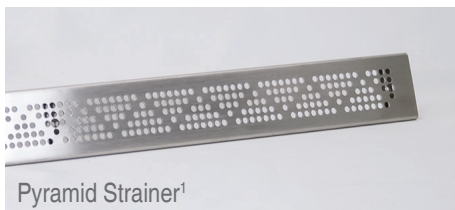
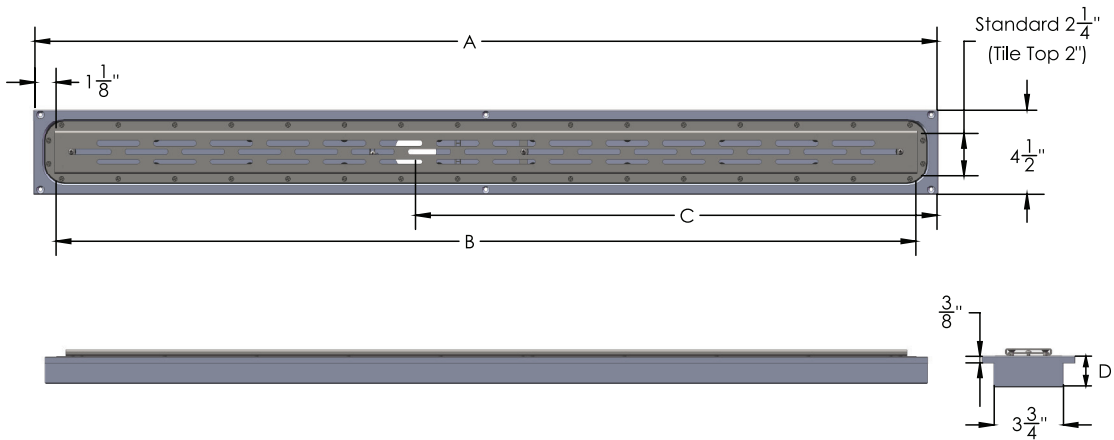

¹Complies with ADA guidelines for handicapped accessible showers.

