

MAPEGUARD BOARD

Multi-purpose, lightweight waterproof panel for the installation of all types of ceramic and natural stone finishes

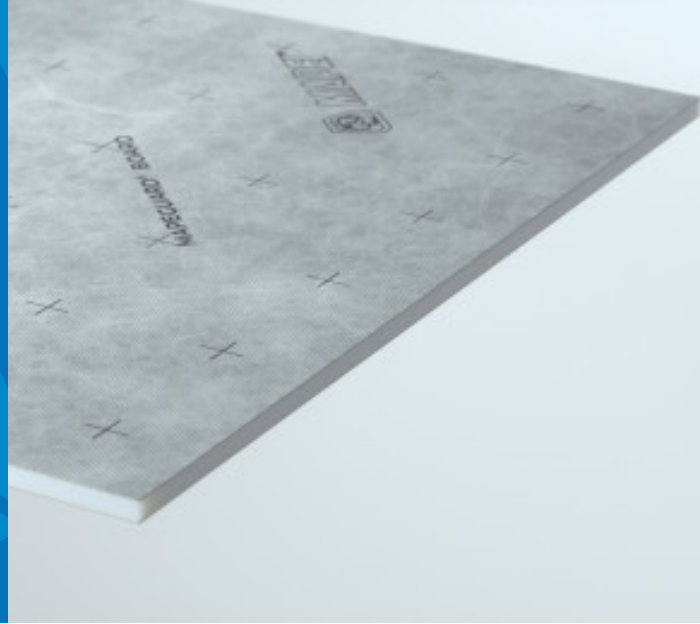

ADVANTAGES

Mapeguard Board may be used to quickly create partition walls or furnishing features in internal surroundings such as bathrooms, kitchens, hallways, access areas, etc. The panels may be cut to size very easily using a conventional cutter according to the dimensions required for the structure, element or feature to be created. **Mapeguard Board** is available in various thicknesses in order to create structures, elements or features for different types of use. It is very easy and quick to install the panels and building work can be carried out without creating dust, unlike with more traditional building materials. The surface of **Mapeguard Board** has been specifically created to provide good adhesion for ceramic tiles, mosaics and natural stone and for the application of skim coats. Also, the special layout of the panels makes them easier to cut to size and mark-ups useful for installers may be added on the surface of the panels. **Mapeguard Board** is resistant to moisture in all layers which means it may be used in areas where there is possible contact with water. Using **Mapeguard Board** it is possible to create perfectly flat, waterproof walls in a single operation. **Mapeguard Board** panels are lightweight and easy to handle which make transport, handling and installation work much easier. They also have high mechanical and insulating properties.

WHERE TO USE

Mapeguard Board is a multi-purpose panel used to create room partitions, a background substrate for furnishing features and to line walls internally. The panel has waterproofing properties and acts as a load-bearing substrate when installing ceramic and natural stone finishes.

Typical application examples

- Levelling of uneven walls, including unplastered walls.
- Levelling of existing surfaces (deteriorated/damaged plaster or old tiling).
- Creating furnishing elements such as shelves and surrounds for sinks and sanitary ware.
- Creating room partitions and walls for shower cabins.
- Surrounds for bathtubs.
- Creating benches and seats in bathrooms and damp environments, such as health and wellness centres.
- Waterproofing surfaces before installing tiling (**Mapeguard Board** has a waterproof surface: sealing joints between each panel and critical areas such as corners, edges and pipes using special accessory items from the **Mapeguard** system guarantees watertightness of the entire wall or assembly).

Mapeguard Board may be used on the following types of substrate:

- concrete;
- cementitious and gypsum-based plaster (after applying suitable primer such as **Primer G** or **Eco Prim T Plus**);
- existing ceramic wall tiles;
- wooden structures.

TECHNICAL CHARACTERISTICS

Mapeguard Board is a multi-purpose panel for internal use made from high-density extruded polystyrene with a multi-layered waterproof membrane to each side. **Mapeguard Board** is waterproof, versatile, lightweight, solid and easy to cut and has good insulating properties. The panels are available in various sizes and thicknesses, to suit numerous application needs and conditions.

Mapeguard Board	
Panel size (cm)	Panel thickness (mm)
60x130	7
60x130	10
60x260	10
60x260	20
60x260	30
60x260	50

RECOMMENDATIONS

- Suitable for internal application.
- When applying the panels to ceilings, it is recommended to use adhesive and screw fasteners with a washer. If mechanical fasteners are used to fasten the panels to walls, a screw fastener without a washer is sufficient.
- **Mapeguard Board** is waterproof and, to guarantee water-tightness of the entire system or assembly, it is important that all critical areas such as joints, corners, edges and pipes are sealed using the special accessory items from the **Mapeguard** range.
- Do not use in areas or surroundings with rising damp.
- Do not store outside and do not expose **Mapeguard Board** to direct sunlight for more than 30 days.
- The panels must be finished with ceramic tiles or stone.
- If there is a high amount of traffic on site before installing the finishing material, it is recommended to protect the surface of the panels.

APPLICATION PROCEDURE

- After choosing the panel thickness according to the type of application or use, [cut the panels](#) to the size and shape required with a standard cutter. Holes and openings for pipes may be created using a drill with a hole-saw bit or with an appropriate saw.

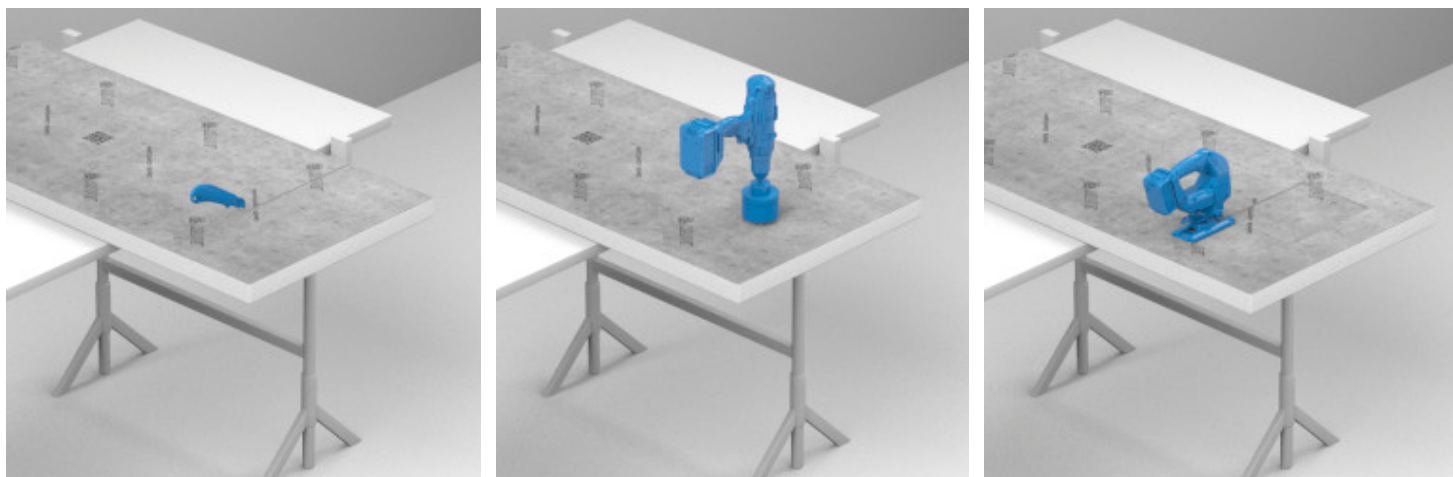

- When [applying to walls](#) as an alternative to plaster, the panels may be bonded directly to the substrate using a [Mapei cementitious adhesive, class C2](#) according to Euronorm EN 12004. A solid layer of adhesive to the back of the board is normally recommended, however, depending on specific site requirements, the adhesive may also be applied in beads and spots as long as sufficient coverage of the contact area on the back of the panel is guaranteed. **Mapeguard Board** is also suitable for use with wall plugs if applied to substrates that are not load-bearing.



· Assembly of the panels used to create walls for shower cabins and furnishing elements may be carried out using a hybrid sealant, such as **Mapeflex MS45**, and mechanical fasteners.



· **Mapeguard Board** has a waterproof surface: to guarantee the waterproofing of the wall or assembled element, it is sufficient to seal the joints between each single panel with **Mapeguard ST** tape and all the critical areas (corners, edges, through elements) with the special accessory items from the **Mapeguard** system (**Mapeguard IC**, **Mapeguard EC**, **Mapeguard PC**). **Mapeguard** accessory items can be applied using **Mapeguard WP Adhesive**.

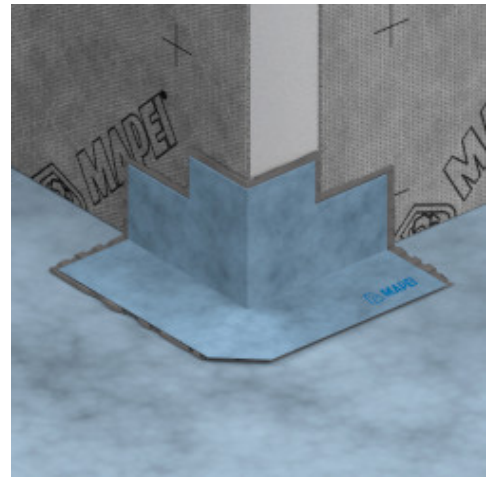
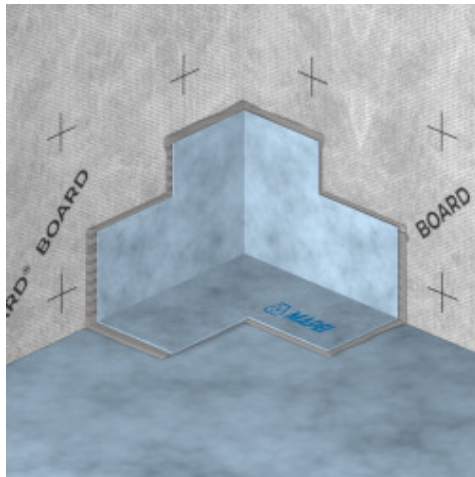
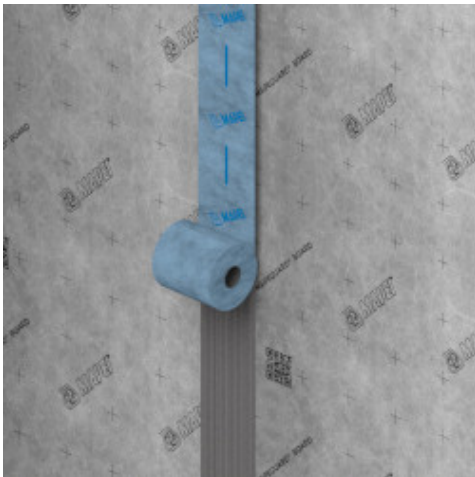



The surface of the panels assembled as described above, which is resistant to water and perfectly flat, can then be finished with any type of ceramic tile, mosaic or stone material suitable for the specific area of use using a Mapei cementitious adhesive of at least class C2, which should be chosen according to the type of finishing material to be bonded.

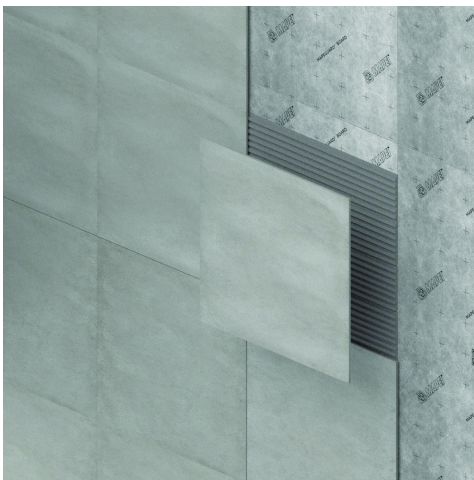

For more details on the correct installation of **Mapeguard Board** panels in some typical areas of application, it is recommended to refer to the Installation Manual, which is available on the company website www.mapei.com, or to contact MAPEI Technical Services.

PACKAGING

All sizes and thicknesses of **Mapeguard Board** construction panels must be stored indoors in horizontal position, protected from UV rays, hot temperatures and humidity.

Standard pallets

	Size of panel (cm)	Thickness of panel (mm)	Number of panels per pack	Number of packs per pallet	Number of panels per pallet
Mapeguard Board	60x130	7	16	10	160
Mapeguard Board	60x130	10	16	7	112
Mapeguard Board	60x260	10	8	14	112
Mapeguard Board	60x260	20	8	7	56
Mapeguard Board	60x260	30	6	4	24
Mapeguard Board	60x260	48	2	7	14

Mixed pallet

	Size of panel (cm)	Thickness of panel (mm)	Contents of mixed pallet
Mapeguard Board	60x130	7	2 packs of 16 panels
Mapeguard Board	60x260	20	2 packs of 8 panels
Mapeguard Board	60x260	30	2 packs of 6 panels
Mapeguard Board	60x260	48	3 packs of 2 panels

SAFETY INSTRUCTIONS FOR PREPARATION AND APPLICATION

Mapeguard Board is an article and referring to the current European regulations (Reg. 1906/2007/EC - REACH) does not require the preparation of the Safety Data Sheet. During use it is recommended to wear protective gloves and goggles and follow the safety requirements of the workplace. PRODUCT FOR PROFESSIONAL USE.

TECHNICAL DATA (typical values)

PHYSIC PROPERTIES

	Reference standard	Unit of measure							Tolerance
Thermal conductivity:	EN 12667	W/mK	0.0342	0.0327	0.0327	0.0341	0.0323	0.0321	± 0.01
Thermal resistance:	EN 12667	m ² K/W	0.205	0.306	0.306	0.587	0.929	1.558	± 15%

MECHANICAL PROPERTIES

Adhesion with cement adhesive (28 days):	EN 1348	N/mm ²	0.3	0.3	0.3	0.3	0.3	0.3	± 0.15
Flexural strength:	ASTM C627 mod	N/mm ²	> 20	> 50	> 50	> 130	> 300	> 750	

DIMENSIONS

- thickness:	mm	7	10	10	20	30	48		± 0,6
- length:	mm	1300	1300	2600	2600	2600	2600		± 3
- width:	mm	600	600	600	600	600	600		± 3

WARNING

Although the technical details and recommendations contained in this product data sheet correspond to the best of our knowledge and experience, all the above information must, in every case, be taken as merely indicative and subject to confirmation after long-term practical application; for this reason, anyone who intends to use the product must ensure beforehand that it is suitable for the envisaged application. In every case, the user alone is fully responsible for any consequences deriving from the use of the product.

Please refer to the current version of the Technical Data Sheet, available from our website www.mapei.com

LEGAL NOTICE

The contents of this Technical Data Sheet ("TDS") may be copied into another project-related document, but the resulting document shall not supplement or replace requirements per the TDS in force at the time of the MAPEI product installation.

The most up-to-date TDS can be downloaded from our website www.mapei.com.

ANY ALTERATION TO THE WORDING OR REQUIREMENTS CONTAINED OR DERIVED FROM THIS TDS EXCLUDES THE RESPONSIBILITY OF MAPEI.

9268-9-2021-gb

Any reproduction of texts, photos and illustrations published here is prohibited and subject to prosecution

