

FIRE & SOUND MANUAL

Underlayments at 3500 psi and Below Evaluation Report R8477	Underlayments Above 3500 psi Evaluation Report R8477	Sound Mats Evaluation Report R8477
<p>MAXXON STANDARD</p> <ul style="list-style-type: none"> • Gyp-Crete® • Gyp-Crete 2000® • Therma-Floor® • Rapid Floor® • Rapid Floor Plus® 	<p>MAXXON HIGH STRENGTH</p> <ul style="list-style-type: none"> • Dura-Cap® • Dek C-Ment® • Level Right® • Commercial Topping® • Level EZ® • Gyp-Crete EZ® 	<p>ENCAPSULATED SOUND MAT</p> <ul style="list-style-type: none"> • All Acousti-Mats® • Acousti-Top® • Maxxon SDF

NOTE REGARDING CANADIAN PROJECTS: Canada accepts all UL Fire Designs listed in this manual. For additional information on Canadian Fire Designs, refer to page 10.

DISCLAIMER: For complete assembly information for a specific fire design, click on the UL number or visit Underwriters’ Laboratories website. While the assemblies of the sound tests were constructed to best represent the most commonly built version of the UL fire design, some variances in construction may have occurred (i.e. within a particular UL rating there can be the allowances for different joist spacing and joist depths, different thicknesses and types of insulation or even no insulation, different types of channel, etc). The sound tests are a representation of what can be expected for sound control ratings when building a floor/ceiling assembly with a specific floor joist assembly that relates to a UL fire design using the designated sound control mat. However, due to the many variables beyond our control (for example quality control of drywall installation, type of resilient channel, density and selection of other building materials, flanking paths, etc.), the sound tests in this resource should not be considered a guarantee of performance. For this same reasoning and the fact that the sound tests were run in different buildings, different laboratories, and different environments, this data can be used for comparison and design evaluation but should not be considered a guarantee of performance. All acoustical testing was done by Architectural Testing; Riverbank Testing Laboratories; Intest, Inc.; Intertek Laboratories; Twin City Testing Corporation; D.L. Adams Associates, L.T.D.; Veneklasen Associates; or Stewart Acoustical Consultants. For assistance determining the right system and UL Fire Rating for your project, contact your Maxxon Regional Representative at (800) 356-7887.



PARALLEL CHORD TRUSS

1 HOUR FIRE DESIGNS

Truss Depth	Insulation	Resilient Channel	Drywall	Min. Topping Depth	Sound Mat	Floor Covering*	Sound Rating			Maxxon UL Fire Ratings	Similar ULs
							STC**	IIC	Test Number		
18"	Yes	Yes	5/8" (16 mm)	3/4" (19 mm)	None	Bare	58	35	H6130.01	L528 L529 L534 L546 L542 L558 L562 L563 L574 L576 L577 L579 L581 L583 L585 L592 M500 M503 M508 M510 ICC ESR #2540 UL ER #8477-01	L521 L550
						LVT		41	H6130.02		
						Carpet & Pad		71	I0101.02		
					Acousti-Mat 1/8	Sheet Vinyl		52	I0101.09		
						LVT	58	50	I0101.07		
						Ceramic Tile		52	I0101.30		
				1" (25 mm)	Acousti-Mat 1/4	Carpet and Pad		72	I0101.11		
						Sheet Vinyl	59	54	I0106.20		
						LVT		53	I0106.18		
						Ceramic Tile		55	I0106.24		
						Engineered Wood		55	I0106.21		
					Acousti-Mat 1/4 Premium	Carpet and Pad		71	I0106.22		
						Sheet Vinyl		55	I0101.17		
						LVT	59	54	I0101.15		
						Ceramic Tile		55	I0101.21		
					Acousti-Mat 3/8	Engineered Wood		55	I0101.18		
						Carpet and Pad		76	I0101.19		
						Sheet Vinyl		56	I0106.28		
				LVT		59	55	I0106.26			
				Ceramic Tile			57	I0106.32			
				Acousti-Mat 3/8 Premium	Engineered Wood		56	I0107.05			
					Carpet and Pad		75	I0106.30			
					LVT	59	57	I0107.27			
					Ceramic Tile		58	I0107.32			
1-1/2" (38 mm)	Acousti-Mat 3/4	Engineered Wood		58	I0107.29						
		Carpet and Pad		79	I0107.30						
		Sheet Vinyl		57	I0101.25						
		LVT	59	56	I0101.23						
		Ceramic Tile		59	I0101.29						
	Acousti-Mat 3/4 Premium	Engineered Wood		57	I0101.26						
		Carpet and Pad		77	I0101.27						
		Sheet Vinyl	58	58	I0107.20						
		LVT		59	I0107.19						
		Ceramic Tile		60	I0107.24						
Engineered Wood		60	I0107.21								
Carpet and Pad		79	I0107.22								

Other Parallel Chord Truss ULs: For special assemblies and other burn ratings including 2 hr designs, additional Parallel Chord Truss UL Fire Ratings exist. Refer to page 10 for a list of these assemblies. The sound tests above are examples of the many sound tests we have on file. Please refer to the disclaimer on the cover of this guide. For assistance determining the right system and UL Fire Rating for your project, contact your Maxxon Regional Representative at (800) 356-7887.

*Contact Maxxon for specific brand, thickness, and installation details. ** All tested assemblies will achieve a minimum of the published result. Specific STC value of the tested assembly listed in the corresponding sound test.



I-JOIST

1 HOUR FIRE DESIGNS

Truss Depth	Insulation	Resilient Channel	Drywall	Min. Topping Depth	Sound Mat	Floor Covering*	Sound Rating			Maxxon UL Fire Ratings
							STC**	IIC	Test Number	
14"	Yes	Yes	2 Layers 5/8" (16 mm)	3/4" (19 mm)	None	Bare	58		TL 96-250	L518 L530 L547 L570 L581 L583 L589 M502 M506 M535 WH J20050694 ICC ESR 1141 ICC ESR 1153 ICC ESR 1305 ICC ESR 1336 ICC ESR 2994 UL ER 8477
						Bare		29	IN 86-1	
						Sheet Vinyl		40	IN 86-2	
						Carpet and Pad		70	IN 86-6	
Acousti-Mat 1/8					Sheet Vinyl	57	50	I0108.09		
					LVT		52	I0110.18		
					Ceramic Tile		50	I0110.24		
					Engineered Wood		51	I0108.10		
Carpet and Pad					77	I0110.22				
Acousti-Mat 1/4				Sheet Vinyl	58	55	I0109.20			
				LVT		54	I0109.18			
				Ceramic Tile		56	I0109.24			
	Engineered Wood		56	I0109.21						
Carpet and Pad		81	I0109.22							
Acousti-Mat 1/4 Premium	Sheet Vinyl	59	55	I0108.33						
	LVT		55	I0108.32						
	Ceramic Tile		57	I0108.37						
	Engineered Wood		56	I0108.34						
Carpet and Pad		83	I0108.35							
Acousti-Mat 3/8	Sheet Vinyl	58	56	I0110.12						
	LVT		55	I0110.10						
	Ceramic Tile		59	I0110.16						
	Engineered Wood		58	I0110.13						
	Carpet and Pad		77	I0110.14						
Acousti-Mat 3/8 Premium	Sheet Vinyl	61	59	I0110.28						
	LVT		57	I0110.26						
	Ceramic Tile		60	I0110.32						
	Engineered Wood		59	I0110.29						
Carpet and Pad		84	I0110.30							
1-1/2" (38 mm)	Acousti-Mat 3/4	Sheet Vinyl	60	58	I0108.25					
		LVT		57	I0108.24					
		Ceramic Tile		59	I0108.29					
		Engineered Wood		59	I0108.26					
		Carpet and Pad		79	I0108.27					

Other I-Joist ULs: For special assemblies and other burn ratings, additional I-Joist UL Fire Ratings exist. Refer to page 10 for a list of these assemblies. The sound tests above are examples of the many sound tests we have on file. Please refer to the disclaimer on the cover of this guide. For assistance determining the right system and UL Fire Rating for your project, contact your Maxxon Regional Representative at (800) 356-7887.

*Contact Maxxon for specific brand, thickness, and installation details. ** All tested assemblies will achieve a minimum of the published result. Specific STC value of the tested assembly listed in the corresponding sound test.



2X10 WOOD JOIST

1 HOUR FIRE DESIGNS

Min. Truss Depth per UL	Insulation	Resilient Channel	Drywall	Min. Topping Depth	Sound Mat	Floor Covering*	Sound Rating			Maxxon UL Fire Ratings
							STC**	IIC	Test Number	
10"	Yes	Yes	5/8" (16 mm)	3/4" (19 mm)	None	None	56		I0111.01	L006 L522 L201 L523 L202 L525 L206 L526 L209 L533 L210 L535 L211 L536 L212 L537 L501 L539 L502 L540 L503 L541 L504 L545 L505 L556 L506 L557 L507 L569 L509 L581 L510 L583 L511 L588 L512 L590 L513 L593 L514 M514 L515 M517 L516 M518 L517 M519 L519 M530 L520 M531
						Sheet Vinyl		44	D8457.19	
						LVT		35	D8457.06	
						Ceramic Tile		29	D8457.01	
						Carpet and Pad		56	IN 81-6	
				1" (25 mm)	Acousti-Mat 1/4	Sheet Vinyl	57	51	I0112.20	
						LVT		51	I0112.19	
						Ceramic Tile		52	I0112.24	
						Engineered Wood		51	I0112.21	
						Carpet and Pad		73	I0112.22	

Other 2x10 ULs: For special assemblies and other burn ratings including 2 hr designs, additional 2x10 Wood Joist UL Fire Ratings exist. Refer to page 10 for a list of these assemblies. The sound tests above are examples of the many sound tests we have on file. Please refer to the disclaimer on the cover of this guide. For assistance determining the right system and UL Fire Rating for your project, contact your Maxxon Regional Representative at (800) 356-7887.

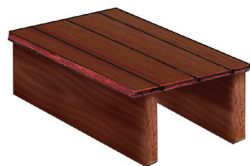

OLD TIMBER

Truss/Joists	Insulation	Resilient Channel	Drywall	Min. Topping Depth	Sound Mat	Floor Covering*	Sound Rating		
							STC**	IIC	Test Number
Dimensional Lumber	No	No	N/A	N/A	None	None	30 FSTC		3018-02-31573.7
								33 FIIC	3018-02-31573.5
				1-1/2" (38 mm)	Acousti-Mat 3/4	Tile	47 FSTC		3018-02-31573.6
						Engineered Wood on Pad		52 FIIC	3018-02-31573.4
						Vinyl		46 FIIC	3018-02-31573.3
				3" concrete (76 mm)	Acousti-Mat 3/4 & Acousti-Mat SBR	Cementitious Overlayment	52 FSTC	51 FIIC	30160-04-62432
Exposed Concrete		47 FIIC	D7299.02-13						

The sound tests above are examples of the many sound tests we have on file. Please refer to the disclaimer on the cover of this guide. For assistance determining the right system for your project, contact your Maxxon Regional Representative at (800) 356-7887.

*Contact Maxxon for specific brand, thickness, and installation details. ** All tested assemblies will achieve a minimum of the published result. Specific STC value of the tested assembly listed in the corresponding sound test.



CONCRETE

1, 2, AND 3 HOUR FIRE DESIGNS

Concrete Depth	Insulation	Resilient Channel	Suspended Ceiling	Drywall	Min. Topping Depth	Sound Mat	Floor Covering*	Sound Rating			Maxxon UL Fire Ratings		
								STC**	IIC	Test Number			
4"	No	No	No	None	1" (25 mm)	Acousti-Mat 1/4	Concrete Micro-Topping		50 FIIC	30160-03-57761	J804 J805		
					2" (51 mm)	Acousti-Mat 3/4	Concrete Micro-Topping		59 FIIC	30160-03-57761			
6"	No	No	No	No	N/A	Acousti-Top	LVT	52	52	H8289.01	N/A ¹		
							Tile		ΔIIC 22	H8289.01			
8"	No	No	No	None	N/A	None	None	62 FSTC		18-0-0607.1			
							None	39 FIIC	18-0-0607.3				
							LVT	62 FSTC		18-0-0607.2			
							Hardwood		64 FIIC	18-0-0607.5			
							Tile		60 FIIC	18-0-0607.7			
			Yes	5/8" (16 mm)	N/A	None	None	None	None	62 FSTC			30160-03-72550-7
									None	70 FIIC		30160-05-72550-9	
									None	61 FIIC		30160-03-56381-5	
									None	42 FIIC	30160-06-77973-1		
									None	42 FIIC	30160-06-77973-2		
1-1/2" (38 mm)	Acousti-Mat 3/8	Tile	None	None	None	Hardwood		60 FIIC	30160-06-77870				
						Tile		54 FIIC	30160-06-77870				
						1" (25 mm)	Acousti-Mat 1/4	Tile	60 FIIC	30160-05-67282-2			
						1-1/2" (38 mm)	Acousti-Mat 3/8	Tile	66 FIIC	30160-05-67282-1			
1-1/2" (38 mm)	Acousti-Mat 3/4	Tile	None	None	None	Tile	74 F-IIC	30160-05-67282-3					

¹ Fire Ratings over 6"+ concrete do not require gypsum concrete. The sound tests above are examples of the many sound tests we have on file. Please refer to the disclaimer on the cover of this guide. For assistance determining the right system and UL Fire Rating for your project, contact your Maxxon Regional Representative at (800) 356-7887.

*Contact Maxxon for specific brand, thickness, and installation details. ** All tested assemblies will achieve a minimum of the published result. Specific STC value of the tested assembly listed in the corresponding sound test.

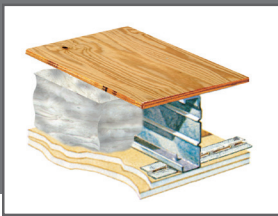

STEEL JOIST/PLYWOOD SUBFLOOR

1 HOUR FIRE DESIGNS

Subfloor	Insulation	Resilient Channel	Drywall	Min. Topping Depth	Sound Mat	Floor Covering*	Sound Rating			Maxxon UL Fire Ratings
							STC**	IIC	Test Number	
3/4" T&G Plywood	Yes	Yes	5/8" (16 mm)	3/4" (19 mm)	None	Carpet & Pad	51 FSTC		4140-94-2168.1	L527 L564 L567 L573
						LVT		73 FIIC	4140-94-2168.2	
								49 FIIC	4140-94-2278	
					Acousti-Mat 1/8	None	58 FSTC		CRA-iSpan-10	
						Hardwood		55 FIIC	CRA-iSpan-7	
						Tile		49 FIIC	CRA-iSpan-8	
				Acousti-Mat 1/4	Vinyl		53 FIIC	CRA-iSpan-11		
					None	59 FSTC		CRA-iSpan-14		
					LVT		53 FIIC	CRA-iSpan-13		
				Acousti-Mat 3/4	Vinyl		52 FIIC	CRA-iSpan-15		
					Tile		57 FIIC	FIIC 04-22-1		
					Vinyl		57 FIIC	FIIC 04-22-2		
		Acoustic Clips	2 layers 5/8" (2 x 16 mm)	1" (25 mm)	Acousti-Mat 1/4	Hardwood		58 FIIC	FIIC 04-22-3	
						Tile		56 FIIC	06-24-1	
						Carpet & Pad		71 FIIC	06-24-2	

The sound tests above are examples of the many sound tests we have on file. Please refer to the disclaimer on the cover of this guide. For assistance determining the right system and UL Fire Rating for your project, contact your Maxxon Regional Representative at (800) 356-7887.

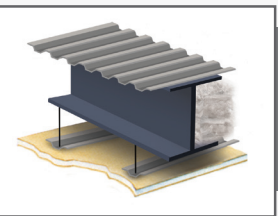

COMPOSITE STEEL/ CONCRETE FLOOR CEILING ASSEMBLIES

Concrete Depth	Insulation	Ceiling	Drywall	Min. Topping Depth	Sound Mat	Floor Covering*	Sound Rating			Maxxon UL Fire Ratings
							STC**	IIC	Test Number	
3 1/2" Concrete over Steel Deck	No	Hat Channel Attached to Joist	5/8" (16 mm)	None	None	None	57	28	TL 01-213, IN 01-8	G561
3" Concrete over 9/16" Corrugated Steel Deck	Yes	Wire Hung Grid 17 1/2" Airspace Deck to Ceiling	5/8" (16 mm) Drywall	None	None	None	55	47	3193995CRT-001.8	
				None	Acousti-Top	Engineered Wood		64	3193995CRT-001.5	
2 1/2" Lightweight Concrete over Steel Deck	Yes	Wire Hung Grid 34" Airspace Deck to Ceiling	5/8" (16 mm)	None	Acousti-Top	Tile		66 FIIC	NAC Centerpoint	D502
				3/8" (10 mm)	Acousti-Top	Engineered Wood		64 FIIC	NAC Centerpoint	
				1" (25 mm)	Acousti-Mat 1/4	Engineered Wood		64 FIIC	NAC Centerpoint	

*Contact Maxxon for specific brand, thickness, and installation details. ** All tested assemblies will achieve a minimum of the published result. Specific STC value of the tested assembly listed in the corresponding sound test.



STEEL TRUSS/STEEL DECK

1 AND 2 HOUR FIRE DESIGNS

Subfloor	Insulation	Resilient Channel	Drywall	Min. Topping Depth	Sound Mat	Floor Covering*	Sound Rating			Maxxon UL Fire Ratings	Similar ULs	
							STC**	IIC	Test Number			
Steel Deck	Yes	Yes	2 layers 5/8" (2 x 16 mm)	3/4" (19 mm)	None	Bare	56	39	10115.01	G551 ¹ G553 ¹ G560 ¹ G563 ¹ G566 ¹ G574 ¹ G587 G592 G597 H502 M511 ICC ESR # 2540 ¹ UL ER # 8477-01 ¹	6564 6577 6578 6579 6580 6581 6582	
						Carpet and Pad		73	10115.02			
					Acousti-Mat 1/8	Sheet Vinyl	56	51	10117.04			
						LVT		51	10117.03			
						Engineered Wood		52	10117.05			
						Carpet and Pad		73	10117.06			
					1" (25 mm)	Acousti-Mat 1/4	Sheet Vinyl		53			10114.04
							LVT	56	52			10114.02
				Ceramic Tile				55	10114.08			
				Engineered Wood				54	10114.05			
				Carpet and Pad			82	10114.06				
				Acousti-Mat 3/8		Sheet Vinyl		53	10115.10			
						LVT	56	53	10115.09			
						Ceramic Tile		56	10115.14			
					Engineered Wood		55	10115.11				
				Carpet and Pad		80	10115.12					

¹ See UL for specific design detail difference between ratings.

The sound tests above are examples of the many sound tests we have on file. Please refer to the disclaimer on the cover of this guide. For assistance determining the right system and UL Fire Rating for your project, contact your Maxxon Regional Representative at (800) 356-7887.

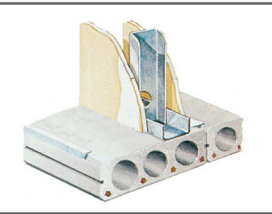

PRECAST CONCRETE

1, 2, AND 3 HOUR FIRE DESIGNS

Concrete Depth	Insulation	Resilient Channel	Suspended Ceiling	Drywall	Min. Topping Depth	Sound Mat	Floor Covering*	Sound Rating			Maxxon UL Fire Ratings
								STC**	IIC	Test Number	
6"	Yes	Yes	Yes	5/8" (16 mm)	1" (25 mm)	Acousti-Mat 1/4	Tile	59		TL98-108	J917 J919 J920 J924 J927 J931 J957 J958 J991 J994 ICC ESR # 2540 UL ER # 8477-01
									57	IN98-12	
8"	No	No	No	None	1/2" (13 mm)	None	None	58 FSTC		5-896	
							Carpet		75 FIIC	5-896-2	
						Acousti-Mat 1/8	None		18 FIIC	B2863.13	
							Tile		54 FIIC	B2863.04	
					3/4" (19 mm)	LVT		56 FIIC	B2863.05		
						Engineered Wood		58 FIIC	B2863.06		
					1" (25 mm)	Acousti-Mat 1/4	None	61 FSTC		B5011.04	
							Tile		59 FIIC	B5011.04	
						LVT		57 FIIC	B5011.04		
						Acousti-Mat 3/8	Tile		61 FIIC	B2863.07	
Wood		61 FIIC	B2863.09								

The sound tests above are examples of the many sound tests we have on file. Please refer to the disclaimer on the cover of this guide. For assistance determining the right system and UL Fire Rating for your project, contact your Maxxon Regional Representative at (800) 356-7887.

*Contact Maxxon for specific brand, thickness, and installation details. ** All tested assemblies will achieve a minimum of the published result. Specific STC value of the tested assembly listed in the corresponding sound test.



MASS TIMBER

CROSS LAMINATED TIMBER (CLT)

CLT

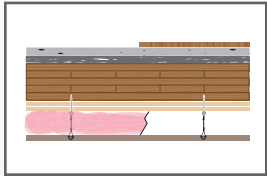
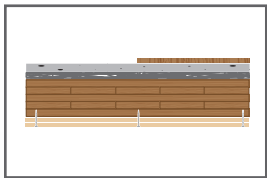
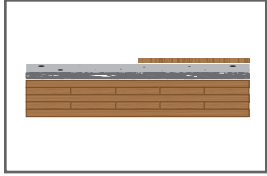

CLT Assembly	Ceiling Configuration	Gypsum Pour (in)	Resilient Channel	Insulation	Encapsulated Mat	Topical Mat	Floor Covering*	Sound Rating			Maxxon UL Fire Ratings
								STC**	IIC	Test Number	
5-ply (7")	EXPOSED Exposed CLT	2" (51 mm)	None	n/a	Acousti-Mat 3/8 Premium	None	Bare Gypsum	52	38	G2463.01	L901 M533
						2 mm Armstrong Pad	LVT		51	G2463.08	
		2" (51 mm) †			Acousti-Mat 3/4 Premium + Acousti-Mat SBR	None	Bare Concrete	52	46	K1276.01	
						Acousti-Top	LVT on Concrete		52	K1276.02	
	DRYWALL DIRECT 2 Layers 5/8" (16mm) directly applied to CLT	1" (25 mm)	None	n/a	Acousti-Mat 3/8 Premium	None	Bare Gypsum	52	46	K1279.01	
							LVT		48	K1279.02	
							Engineered Wood		47	K1279.04	
		2" (51 mm) †			Acousti-Mat 3/4 Premium + Acousti-Mat SBR	None	Bare Concrete	59	52	K1277.01	
	Acousti-Top	LVT on Concrete		55		K1277.02					
	SUSPENDED CEILING 2 Layers 5/8" (16mm) directly applied to CLT + 1 layer 5/8" (16 mm) hung	0.75" (19 mm)	Wire Hung, Armstrong IIC Clip + 6" Air Space	No	Acousti-Mat 1/8	None	Bare Gypsum	59	51	K1278.01	
							LVT		54	K1278.02	
							Engineered Wood		55	K1278.04	
1" (25 mm)		Acousti-Mat 3/8 Premium			Bare Gypsum	63	60	K1279.05			
					LVT		63	K1279.06			
					Engineered Wood		62	K1279.08			

† Normal-weight concrete topping slab.

CLT COMPOSITE

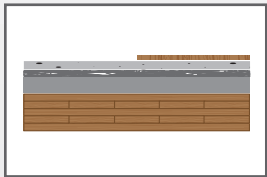

CLT Assembly	Ceiling Configuration	Gypsum Pour (in)	Resilient Channel	Insulation	Encapsulated Mat	Topical Mat	Floor Covering*	Sound Rating		
								STC**	IIC	Test Number
5.4" 5-ply + 2.25" Concrete Composite	EXPOSED Exposed Composite CLT	1" (25mm)	None	n/a	Acousti-Mat 3/8	None	Bare Gypsum	52	50	K3094.97
							Engineered Wood		52	K3094.69
		1-1/2" (38mm)			Acousti-Mat 3/4 Premium + Acousti-Mat SBR	None	Bare Gypsum	56	57	K3094.98
						Acousti-Top	Engineered Wood		61	K4507.06

*Contact Maxxon for specific brand, thickness, and installation details. ** All tested assemblies will achieve a minimum of the published result. Specific STC value of the tested assembly listed in the corresponding sound test.



MASS TIMBER

LAMINATED VENEERS (VLT)

VLT

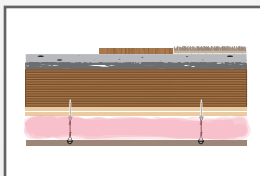
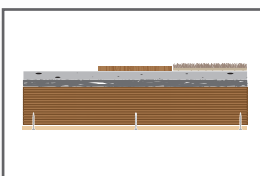
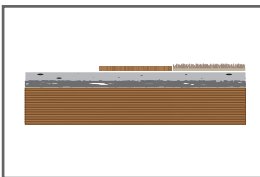

CLT Assembly	Ceiling Configuration	Gypsum Pour (in)	Resilient Channel	Insulation	Encapsulated Mat	Topical Mat	Floor Covering*	Sound Rating		
								STC**	IIC	Test Number
6-3/8"	EXPOSED Exposed VLT	2" (51 mm)	None	n/a	Acousti-Mat 3/8 Premium	None	Bare Gypsum		41	L3827.03
							Engineered Wood	52	48	L3827.08
							LVT		45	L3827.04
						Acousti-Top	LVT		49	L3827.05
						None	Carpet and Pad		83	L3827.10
						Acousti-Mat 3/4 Premium + Acousti-Mat SBR	None	Bare Gypsum		49
					Engineered Wood				53	L3827.60
					Acousti-Top			Engineered Wood	57	54
					None		LVT		52	L3827.56
					Acousti-Top		LVT		54	L3827.57
					None		Carpet and Pad		79	L3827.62
					DRYWALL DIRECT 2 Layers 5/8" (16mm) directly applied to VLT	2" (51 mm) [†]	None	n/a	Acousti-Mat 3/8 Premium	None
	Engineered Wood		48	L3827.16						
	LVT		46	L3827.12						
	Acousti-Top	LVT	52	50						L3827.13
	None	Carpet and Pad		83						L3827.18
	Acousti-Mat 3/4 Premium + Acousti-Mat SBR	None	Bare Gypsum							51
			LVT						54	L3827.64
			Acousti-Top	LVT						56
		None	Engineered Wood	58					53	L3827.68
		Acousti-Top	Engineered Wood						55	L3827.69
		None	Carpet and Pad						79	L3827.70
	SUSPENDED CEILING 2 Layers 5/8" (16mm) directly applied to VLT + 1 layer 5/8" (16 mm) hung	1" (25mm)	Wire Hung, Armstrong IIC Clip + 6" Air Space	No					Acousti-Mat 1/8	None
					Engineered Wood		54	L3827.39		
LVT						53	L3827.38			
Acousti-Mat 3/8 Premium					None	Bare Gypsum		58	L3827.19	
		Engineered Wood				62	59	L3827.23		
		LVT					59	L3827.20		
Acousti-Mat 3/4 Premium + Acousti-Mat SBR		None			Bare Gypsum	61	60	L3827.71		
					Engineered Wood		62	L3827.73		
					LVT		62	L3827.72		
1" (25mm)		Yes			Acousti-Mat 1/8	None	Bare Gypsum	60	61	L3827.45
							Engineered Wood		64	L3827.47
							LVT		64	L3827.46
	Acousti-Mat 3/8 Premium		None	Bare Gypsum	61	61	L3827.27			
Engineered Wood					63	L3827.31				
LVT					64	L3827.28				
2" (51mm)	Acousti-Mat 3/4 Premium + Acousti-Mat SBR		None	Bare Gypsum	62	64	L3827.79			
				Engineered Wood		65	L3827.81			
				LVT		66	L3827.80			

*Contact Maxxon for specific brand, thickness, and installation details. ** All tested assemblies will achieve a minimum of the published result. Specific STC value of the tested assembly listed in the corresponding sound test.

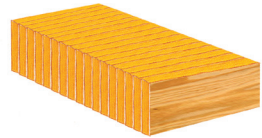

MASS TIMBER

DOWEL LAMINATED TIMBER (DLT)

DLT

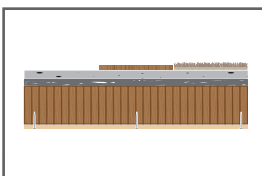
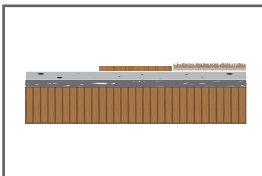

DLT Assembly	Ceiling Configuration	Gypsum Pour (in)	Resilient Channel	Insulation	Encapsulated Mat	Topical Mat	Floor Covering*	Sound Rating		
								STC**	IIC	Test Number
6"	EXPOSED Exposed DLT	1-1/2" (38 mm)	None	n/a	Acousti-Mat 3/8 Premium	None	Bare Gypsum	54	45	K1274.01
							LVT		47	K1274.02
							Engineered Wood		47	K1274.04
	DRYWALL DIRECT 2 Layers 5/8" (16mm) directly applied to DLT						Bare Gypsum	56	47	K1275.01
							LVT		49	K1275.02
							Engineered Wood		49	K1275.04



MASS TIMBER

MASS PLYWOOD PANEL (MPP)

MPP

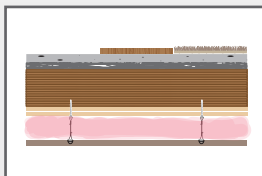
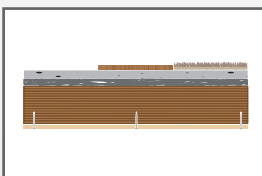
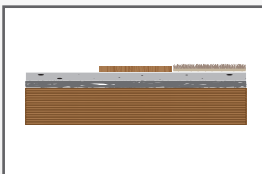

MPP Assembly	Ceiling Configuration	Gypsum Pour (in)	Resilient Channel	Insulation	Encapsulated Mat	Topical Mat	Floor Covering*	Sound Rating					
								STC**	IIC	Test Number			
5"	EXPOSED Exposed MPP	1-1/2" (38 mm)	None	n/a	Acousti-Mat 3/4 Premium	None	Bare Gypsum	54	41	K1283.00A			
						Acousti-Top	LVT		44	K1283.01			
	DRYWALL DIRECT 2 Layers 5/8" (16mm) directly applied to MPP			None		Bare Gypsum	54	44	K1283.00B				
				Acousti-Top		LVT		46	K1283.02				
	SUSPENDED CEILING 2 Layers 5/8" (16mm) directly applied to MPP + 1 layer 5/8" (16 mm) hung		None	Bare Gypsum		61	52	K1283.03					
			None	LVT			55	K1283.04					
			None	Engineered Wood			55	K1283.06					
	EXPOSED Exposed MPP		2" (51 mm) [†]	None		None	n/a	Acousti-Mat 3/4 Premium + Acousti-Mat SBR	None	Bare Concrete	57	47	K1282.01
									Acousti-Top	LVT on Concrete		51	K1282.02

[†] Normal-weight concrete topping slab.

*Contact Maxxon for specific brand, thickness, and installation details. ** All tested assemblies will achieve a minimum of the published result. Specific STC value of the tested assembly listed in the corresponding sound test.

MISCELLANEOUS UL FIRE DESIGNS

PARALLEL CHORD TRUSS

UL #	Unique Assembly Details
L529	Suspended Ceiling
L542	Furring Channels/Drywall Screwed Direct
L556	2HR/4 Layers of Drywall
L577	2HR/3 Layers of Drywall
L581	Kinetics ICW Clip, Batt Insulation, 2 Layers 5/8" Gypsum Board
L583	Kinetics Isomax Clip, Batt Insulation, 2 Layers of 5/8" Gypsum Board
M500	2HR/3+ Layers of Drywall
M510	2HR/3 Layers of Drywall - 1 Layer Screwed Direct

2X10

UL #	Unique Assembly Details
M504	0.75 HR/Drywall Screwed Direct
M514	Sound Break Gypsum Board from National Gypsum
L581	Kinetics ICW Clip, Batt Insulation, 2 Layers 5/8" Gypsum Board
L583	Kinetics Isomax Clip, Batt Insulation, 2 Layers of 5/8" Gypsum Board

ULC DESIGN

#	Hour Rating	Type of Construction
I530	1.5, 2	TotalJoist by iSPAN®
L003	1	2" x 10" Wood Joist
L201	1	2" x 10" Wood Joist
L511	2	2" x 10" Wood Joist
L512	1	2" x 10" Wood Joist (Commercial Construction Only)
M500	1	2" x 10" Wood Joist
M501	1	2" x 10" Wood Joist
M503	2	2" x 10" Wood Joist
M514	2	Parallel Chord Truss or Steel Frame
M520	1	TotalJoist by iSPAN®
M521	1	TotalJoist by iSPAN®

Canada also accepts all UL Fire Designs listed in this manual. For verification of a UL Fire Design for Canada, refer to the UL Environment document CCOX7.R8477 "Floor- and Roof-topping Mixtures Certified for Canada", which can be obtained by contacting your Maxxon Regional Representative or at www.ul.com.

I-JOIST

UL #	Unique Assembly Details
L518	TJI®/Resilient Channel
L530	TJI®/Simpson Strong Clips
L538	2HR/3 Layers of Drywall
L547	TJI®/Resilient Channel
L556	2HR/Wilamette I Beam Truss/4 Layers of Drywall
L581	Kinetics ICW Clip, Batt Insulation, 2 Layers 5/8" Gypsum Board
L583	Kinetics Isomax Clip, Batt Insulation, 2 Layers of 5/8" Gypsum Board

STEEL JOIST

UL #	Steel Joist Manufacturer
G230	2HR/Midcon MetalEdge concrete T&G plank
G516	2HR/Midcon MetalEdge concrete T&G plank
G592	1, 2HR/Plycem Board
H502	1, 1½, 2HR/Plycem Board

For assistance determining the right systems and UL Fire Rating for your project, contact your Maxxon Regional Representative at (800) 356-7887.



For more info: 800-356-7887 • Email: info@maxxon.com
www.Maxxon.com

Another superior product from:
Maxxon® Corporation • 920 Hamel Road • P.O. Box 253
Hamel, MN 55340 USA • 763-478-9600 • Fax: 763-478-2431

