

www.mkdiamond.com

MK-SINGLE DISC GRINDER OWNERS MANUAL PARTS LIST & OPERATING INSTRUCTIONS



SDG-3



SDG-11

Revision 202	11.2011
Manual 158273	

Caution: Read all safety and operating instructions before using this equipment. This parts list **MUST** accompany the equipment at all times.

INTRODUCTION

Congratulations on your purchase of a MK-SDG Grinder. We are certain that you will be pleased with your purchase. MK Diamond takes pride in producing the finest construction power tools and diamond blades in the industry.

Operated correctly, your MK-SDG Grinder should provide you with years of service. In order to help you, we have included this manual. This owners manual contains information necessary to operate and maintain your MK-SDG Grinder safely and correctly. Please take the time to familiarize yourself with the MK-SDG Grinder by reading and reviewing this manual.

Read and follow all safety, operating and maintenance instructions.

If you should have questions concerning your MK-SDG Grinder, please feel free to call our friendly customer service department at: 800 421-5830

Regards,

MK Diamond

NOTE THIS INFORMATION FOR FUTURE USE:

MODEL NUMBER:	
SERIAL NUMBER:	
PURCHASE PLACE:	
PURCHASE DATE:	

NOTE: For your (1) one year warranty to be effective, complete the warranty card (including the Serial Number) and mail it in as soon as possible.

TABLE OF CONTENTS

SAFETY

Safety Messages	4
Damage Prevention Message	4
General Safety Precautions and Hazard Symbols	4
Rules for Safe Operation	5
California Proposition 65 Message	6
Electrical Requirements	8-10
Safety Label Locations	11
Product Specifications	12

UNPACKING and TRANSPORT

Unpacking	13
Contents	13
Transport	13

ASSEMBLY and OPERATION

Handlebar Adjustment	14
Grinding Discs Installation	14
Gasoline Engine Unit	15
Electric Motor Unit	15

MAINTENANCE AND TROUBLESHOOTING

Cleanup	16
Filling Fuel Tank	16

EXPLODED VIEW AND PARTS LIST

Exploded View	18-20
Parts List	21-24

ACCESSORIES ORDERING and RETURN INSTRUCTIONS

Accessories	26
Ordering Information	27
Return Material Policy	27
Packaging Instructions	27
Authorized Service Centers	27

Read and follow all safety, operating and maintenance instructions. Failure to read and follow these instructions could result in injury or death to you or others. Failure to read and follow these instructions could also result in damage and/or reduced equipment life.

SAFETY MESSAGES

A safety message alerts you to potential hazards that could hurt you or others. Each safety message is preceded by a safety alert symbol () and one of three words: **DANGER**, **WARNING**, or **CAUTION**.



DANGER You **WILL** be **KILLED** or **SERIOUSLY INJURED** if you do not follow directions.



WARNING You **CAN** be **KILLED** or **SERIOUSLY INJURED** if you do not follow directions.



CAUTION You **CAN** be **INJURED** if you do not follow directions. It may also be used to alert against unsafe practices.

DAMAGE PREVENTION AND INFORMATION MESSAGES

A Damage Prevention Message is to inform the user of important information and/or instructions that could lead to equipment or other property damage if not followed. Information Messages convey information that pertains to the equipment being used. Each message will be preceded by the word **NOTE**, as in the example below.

NOTE: Equipment and/or property damage may result if these instructions are not followed.

GENERAL SAFETY PRECAUTIONS AND HAZARD SYMBOLS

In order to prevent injury, the following safety precautions and symbols should be followed at all times!

SAFETY PRECAUTIONS



ALWAYS read this Owner's Manual before operating the machine.



ALWAYS keep the Blade Guards in place.



REMOVE ADJUSTING KEYS AND WRENCHES

Form a habit of checking to see that keys and adjusting wrenches are removed from the power tool before it is turned on.



KEEP WORK AREA CLEAN

Cluttered work areas and benches invite accidents.



DO NOT USE IN DANGEROUS PLACES

DO NOT use power tools in damp or wet locations nor expose them to rain. Always keep the work area well lighted.



KEEP CHILDREN AWAY

All visitors and children should be kept a safe distance from work area.

**MAKE THE WORKSHOP KID PROOF**

Make the workshops kid proof by using padlocks, master switches or by removing starter keys.

**DO NOT FORCE THE TOOL**

A power tool will do a job better and safer operating at the rate for which it was designed.

**USE THE RIGHT TOOL**

DO NOT force a tool or an attachment, to do a job that it was not designed to do.

**USE THE PROPER EXTENSION CORD**

If using an extension cord make sure it is in good condition first. When using an extension cord, be sure to use one heavy enough to carry the current your product will draw. An undersized cord will cause a drop in line voltage that will result in a loss of power and overheating. TABLE 1, Page 10 shows the correct AWG size to use depending on cord length and nameplate ampere rating. If in doubt, use the next heavier gage. The smaller the gage number, the heavier the cord.

USE PROPER APPAREL

DO NOT wear loose clothing, gloves, neckties, rings, bracelets, or other jewelry that may be caught in moving parts. Non-slip footwear is recommended. Wear protective hair covering to contain long hair.



ALWAYS wear approved eye protection.



ALWAYS wear approved respiratory protection.

**SECURE WORK**

Clamps or a vise should be used to hold work whenever practical. Keeping your hands free to operate a power tool is safer.

**DO NOT OVERREACH**

Keep proper footing and balance at all times by not overreaching.

**MAINTAIN TOOLS WITH CARE**

Keep tools clean for the best and safest performance. Always follow maintenance instructions for lubricating, and when changing accessories.

**DISCONNECT TOOLS**

Power tools should always be disconnected before servicing or when changing accessories, such as blades, bits, cutters, and the like.



ALWAYS place the power ON/OFF switch in the **OFF** position when the saw is not in use.

**USE RECOMMENDED ACCESSORIES**

Consult the owner's manual for recommended accessories. Using improper accessories may increase the risk of personal or by-stander injury.

**NEVER STAND ON THE TOOL**

Serious injury could occur if a power tool is tipped, or if a cutting tool is unintentionally contacted.

**CHECK FOR DAMAGED PARTS**

Before using a power tool, check for damaged part. A guard or any other part that is damaged should be carefully checked to determine if would operate properly and perform its intended function. Always check moving parts for proper alignment or binding. Check for broken parts and mountings and all other conditions that may affect the operation of the power tool. A guard, or any damaged part, should be properly repaired or replaced.

**NEVER LEAVE A TOOL UNATTENDED**

TURN POWER OFF - Do not leave a tool until it comes to a complete stop. Always turn a power tool OFF when leaving the work area, or, when a cut is finished.

CALIFORNIA PROPOSITION 65 MESSAGE

**WARNING**

Some dust created by power sanding, sawing, grinding, drilling, and other construction activities contain chemicals known [to the State of California] to cause cancer, birth defects or other reproductive harm. Some examples of these chemicals are:

- Lead, from lead-based paints
- Crystalline silica, from bricks and cement and other masonry products and
- Arsenic and chromium, from chemically treated lumber

For further information, consult the following sources:

<http://www.osha.gov/dsg/topics/silicacrystalline/index.html>

<http://www.cdc.gov/niosh/consilic.html>

<http://oehha.ca.gov/prop65/law/P65law72003.html>

<http://www.dir.ca.gov/Title8/sub4.html>

Your risk from these exposures varies depending on how often you do this type of work. To reduce your exposure to these chemicals, work in a well-ventilated area, and work with approved safety equipment, such as those dust masks that are specially designed to filter out microscopic particles.

HAZARD SYMBOLS

**ELECTRICAL SHOCK**

NEVER touch electrical wires or components while the engine is running. They can be sources of electrical shock which could cause severe injury or burns.

**ROTATING PARTS**

Keep hands, feet, hair, and clothing away from all moving parts to prevent injury. Never operate the motor with covers, shrouds, or guards removed.

**OVER SPEED**

NEVER tamper with the governor components or settings to increase the maximum speed. Severe personal injury and damage to the engine or equipment can result if operated at speeds above maximum.

**DO NOT EXPOSE TO RAIN**

DO NOT expose to rain or use in damp locations.

**WARNING**

Sawing, grinding and drilling generates dust. Excessive airborne particles may cause irritation to eyes, skin and respiratory tract. To avoid breathing impairment, always employ dust controls and protection suitable to the material being sawed, grinded, or drilled; See OSHA (29 CFR Part 1910.1200). Diamond Blades improperly used are dangerous. Comply with American National Standards Institute Safety Code, B7.1 and, Occupational Safety and Health Act covering Speed, Safety Guards, Flanges, Mounting Procedures, General Operating Rules, Handling, Storage and General Machine Conditions

ELECTRICAL REQUIREMENTS AND GROUNDING INSTRUCTIONS

In order to prevent potential electrical shock and injury, the following electrical safety precautions and symbols should be followed at all times!



WARNING

In case of a malfunction or breakdown, grounding provides a path of least resistance for electric current to reduce the risk of electric shock. This tool is equipped with an electric cord having an equipment-grounding conductor and a grounding plug. The plug must be plugged into a matching outlet that is properly installed and grounded in accordance with all local codes and ordinances.

- Do not modify the plug provided – if it will not fit the outlet; have the proper outlet installed by a qualified electrician
- Improper connections of the equipment-grounding conductor can result in a risk of electric shock. The equipment-grounding conductor is the insulated conductor that has an outer surface that is green, with or without yellow stripes. If repair or replacement of the electric cord or plug is necessary, do not connect the equipment-grounding conductor to a live terminal
- Check with a qualified electrician or service personnel if the grounding instructions are not completely understood, or if in doubt as to whether the tool is properly grounded
- Use only 3-wire extension cords that have 3-prong grounding plugs and 3-pole receptacles that accept the tool's plug
- Repair or replace a damaged or worn cord immediately



WARNING

This tool is intended for use on a circuit that has an outlet that looks like the one shown in Sketch A. The tool has a grounding plug that looks like the plug illustrated in Sketch A. A temporary adapter, which looks like the adapter illustrated in sketches B and C, may be used to connect this plug to a 2-pole receptacle as shown in Sketch B, if a properly grounded outlet is not available. The temporary adapter should be used only until a properly grounded outlet can be installed by a qualified electrician. The green-colored rigid ear, lug, and the like, extending from the adapter, must be connected to a permanent ground such as a properly grounded outlet box.

NOTE: Use of a temporary adapter is not permitted in Canada.

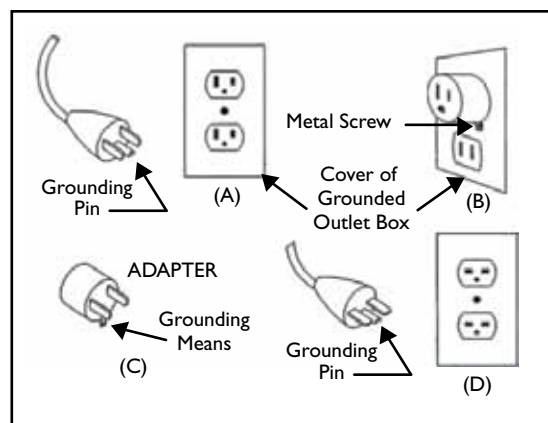

Circuit and Adapter Information

**WARNING**

To avoid the possibility of the appliance plug or receptacle getting wet, position the machine to one side of a wall mounted receptacle. This will prevent water from dripping onto the receptacle or plug. A “drip loop,” shown in the picture below, should be arranged by the user to properly position the power cord relative to the power source.

The “drip loop” is that part of the cord below the level of the receptacle, or the connector, if an extension cord is used. This method of positioning the cord prevents the travel of water along the power cord and coming in contact with the receptacle.

If the plug or receptacle gets wet, **DO NOT** unplug the cord. Disconnect the fuse or circuit breaker that supplies power to the tool. Then unplug and examine for presence of water in the receptacle.

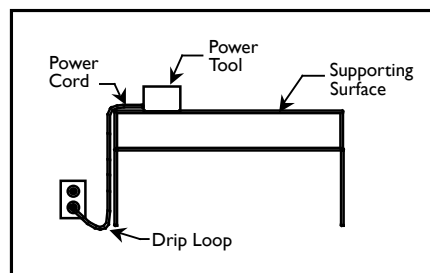

Drip Loop Information

**WARNING**

Use only extension cords that are intended for outdoor use. These extension cords are identified by a marking “Acceptable for use with outdoor appliances; store indoors while not in use.” Use only extension cords having an electrical rating not less than the rating of the product. Do not use damaged extension cords. Examine extension cords before using and replace if damaged. Do not abuse extension cords and do not yank on any cord to disconnect. Keep cords away from heat and sharp edges. Always disconnect the extension cord from the receptacle before disconnecting the product from the extension cord.

**WARNING**

To reduce the risk of electrocution, keep all connections dry and off the ground. Do not touch the plug with wet hands.

**WARNING**

Use of under sized extension cords result in low voltage to the motor that can result in motor burnout and premature failure. MK Diamond warns that equipment returned to us showing signs of being run in a low voltage condition, through the use of undersized extension cords will be repaired or replaced totally at the customer's expense. There will be no warranty claim.

To choose the proper extension cord,

- Locate the length of extension cord needed in the table below.
- Once the proper length is found, move down the column to obtain the correct AWG size required for that length of extension cord.

EXTENSION CORD MINIMUM GAGE FOR LENGTH				
VOLTS	TOTAL LENGTH OF CORD IN FEET			
	25 ft. AWG	50 ft. AWG	100 ft. AWG	150 ft. AWG
115v	14	12	Not Recommended	Not Recommended
230v	N/A	14	12	N/A

OPERATION & SAFETY DECALS

The MK-SDG is equipped with a number of safety decals. These decals are provided for operator safety and maintenance information. Should any of these operation or safety decals become unreadable, replacements can be obtained by calling (800) 262-1575.

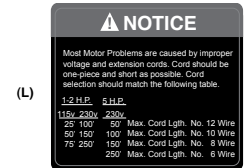
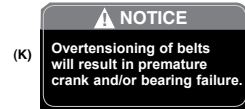
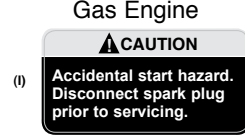
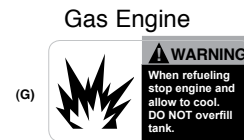
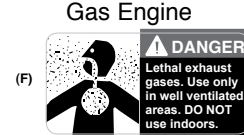
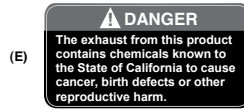
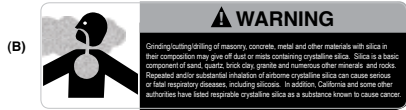
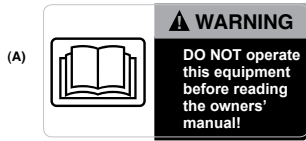

Label Sheet Part# 166010

Electric Engine

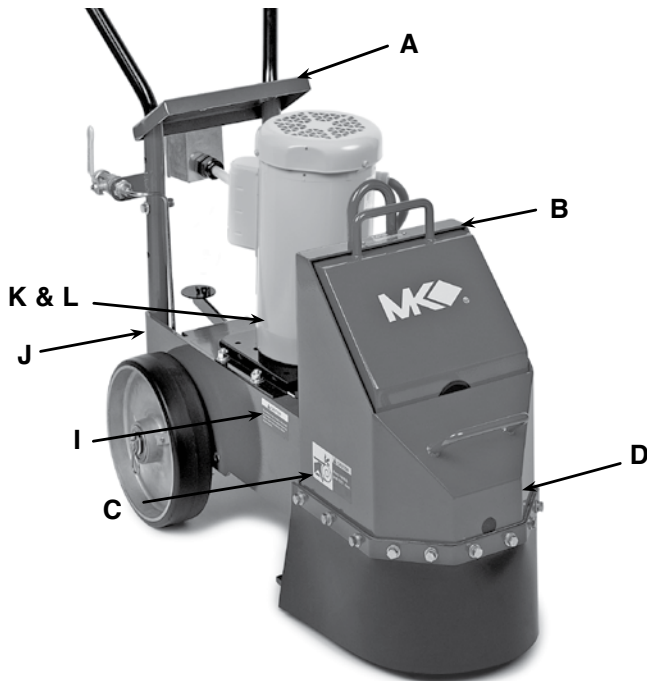

Electric Motor

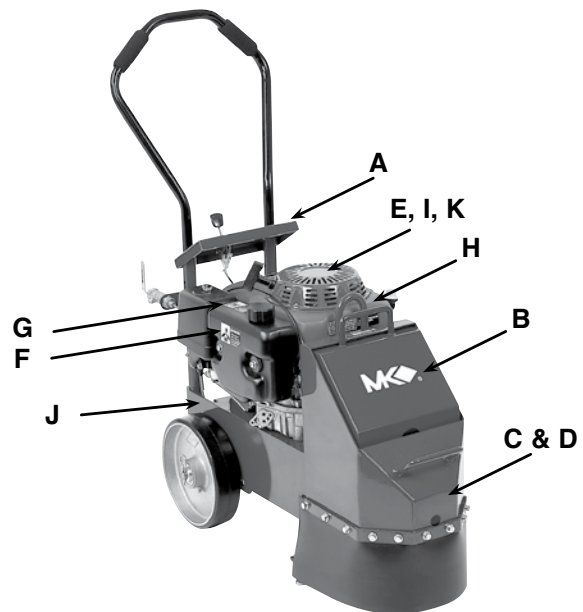

Gas Engine

PRODUCT SPECIFICATIONS

The MK-SDG is a versatile unit. Operated and used according to this manual, the MK-SDG will provide years of dependable service.

FEATURES

- Uses either a 10 or 20 segment 10" diameter diamond grinding discs to level, smooth or clean the top surface of concrete slabs. (A)
- Provides a smoother finish compared to other methods such as scarifiers or scabblers.
- Two-position wheel carriage for grinding and easy transport. (B)
- Front taper for enhanced visibility.
- Removable nose weight and handle for easy transportation. (C)
- Dust shroud helps contain grinding debris.
- Works on concrete slabs, terrazzo, brick, stone and ceramic tile floors.



A

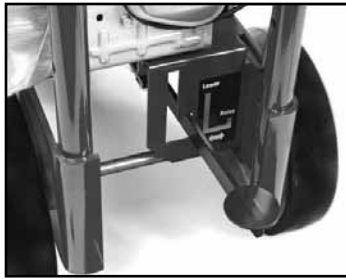

B



C

SPECIFICATIONS

Specifications for the MK-SDG are listed in the table below.

Model	MK-SDG-11	MK-SDG 3
Engine	Honda	Baldor / Leeson
Power	GX340	3 HP
Disc RPM	980	980
Disc Capacity	10" (254mm)	10" (254mm)
Ballast	70 lbs. (32kg)	70 lbs. (32kg)
Weight	212 lbs. (96kg)	212 lbs. (96kg)
LxWxH (inches)	40" x 16" x 42"	40" x 16" x 42"
LxWxH (mm)	1016 x 406 x 1066	1016 x 406 x 1066
Part #	157377	161180

CONTENTS

CAUTION Use proper lifting techniques when lifting the MK-SDG.
 If not already done, remove the MK-SDG, accessory box from the carton.

In your container, you will find

- | | |
|------------------------------|-----------------------|
| One (1) MK-SDG | One (1) Owners Manual |
| One (1) MK-SDG Owners Manual | One (1) warranty card |



MK-SDG



Owners Manual

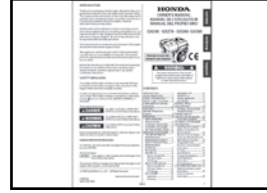

Owners Manual



Warranty Card

TRANSPORT

- CAUTION**
1. The MK-SDG weighs approximately two hundred and twelve (212) pounds; use care when transporting. The unit needs to be rolled from one location to another.
 2. Never try to lift the unit by yourself.

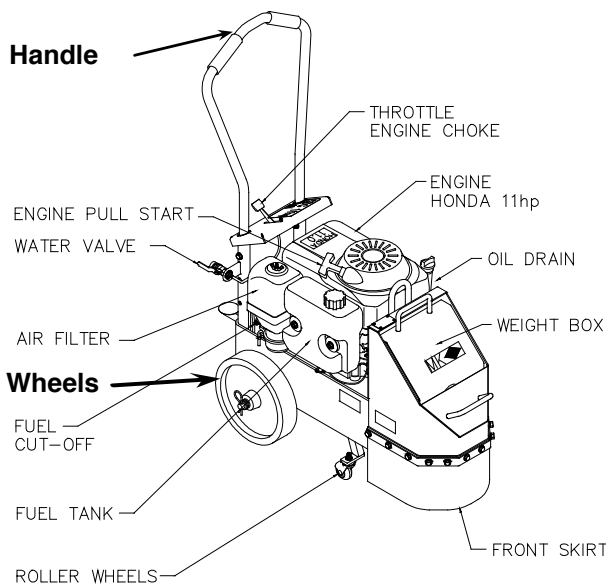

GAS GRINDER

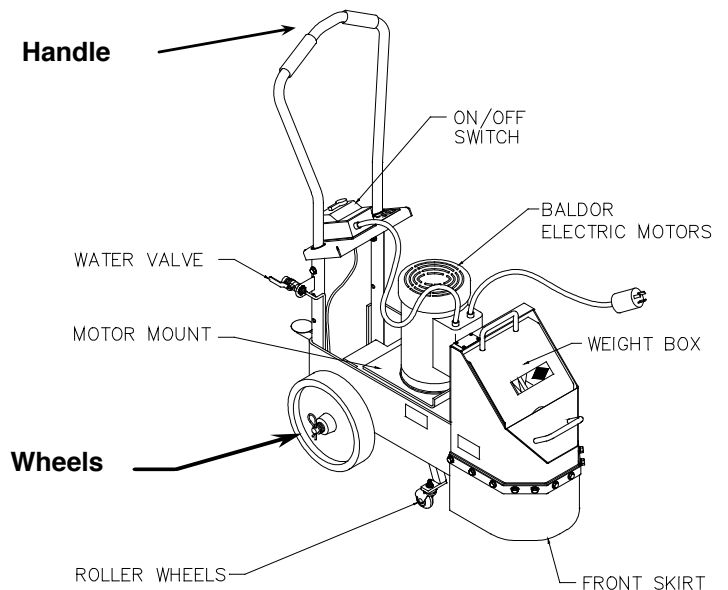

ELECTRIC GRINDER

ASSEMBLY

Follow the diagram below to prepare your MK-SDG for operation.

HANDLEBAR ADJUSTMENT

Adjust the Handlebar, as shown in the figure to the right, for ease of operation and comfort of the user.

GRINDING DISCS INSTALLATION

You need to install the grinding discs before operation of the MK-SDG

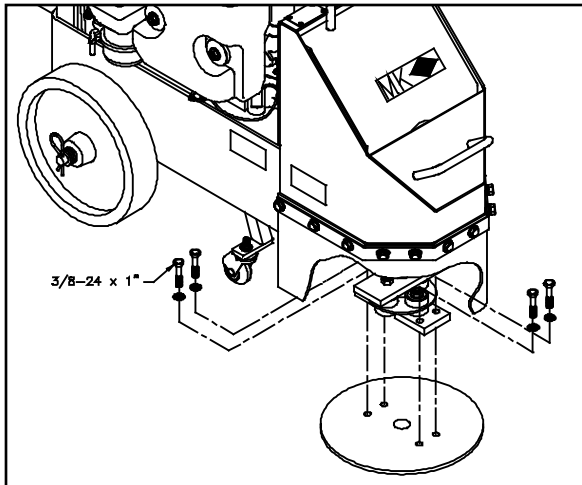

The figure to the left shows the components needed to install the discs.

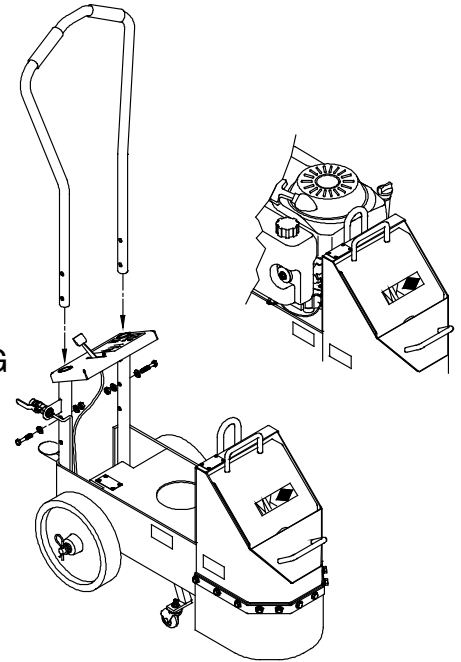

FOR GASOLINE ENGINE

BEFORE STARTING

1. Use correct diamond wheel for grinding conditions.
2. Ensure wheel mountings are clean and bolts are tightened securely.
3. Check water jet for adequate flow.
4. Place grinding wheels on surface.
5. Start and warm up engine. Refer to engine owners manual for details.
6. If application requires water, adjust water flow.
7. Adjust speed as required by application.

DAILY MAINTENANCE

1. Check engine oil level. Refer to engine owners manual for details.
2. Check and clean air filter.
3. Lubricate grease points.
4. Check belt tension
5. Check for fluid leaks and loose or damaged parts.



FOR ELECTRIC MOTOR

BEFORE STARTING

1. Choose correct diamond wheels for the job condition.
2. Ensure grinding wheel mountings are clean and the retaining bolts are securely tightened.
3. Check for adequate water flow. (If water is required.)
4. Be sure the grinding wheels are positioned over the work area.
5. Adjust water flow. (If application requires water)
6. While holding securely to the handlebar, turn power switch to "ON" position. Refer to motor owners manual for details.

DAILY MAINTENANCE

1. Lubricate grease points.
2. Check belt tension.



CLEAN UP

⚠ CAUTION Engine parts are extremely hot following use. Allow engine to cool 1/2 hour before cleaning. Use care during cleanup to avoid injury.

- NOTE:**
1. To extend operating life, the MK-SDG should be cleaned following every use.
 2. Using a garden hose or pressure washer can force water into the air cleaner or muffler opening.
 3. Use care when cleaning around electrical components.

FILLING FUEL TANK

⚠ WARNING

Refer to engine owners manual.

1. Gasoline is highly flammable and explosive. You can be burned or seriously injured when handling fuel.
2. To fuel, stop engine if running, and allow it to cool.
3. Refuel in a well-ventilated area.
4. Keep gasoline away from appliance pilot lights, barbecues, electric appliances, power tools, etc.
5. Wipe up spills immediately

- NOTE:**
1. Fuel can damage paint and plastic. Be careful not to spill fuel when filling the fuel tank.
 2. Damage caused by spilled fuel IS NOT covered under the warranty.
 3. DO NOT use stale or contaminated gasoline, or an oil/gasoline mixture.
 4. Use unleaded gasoline with a pump octane rating of 86 or higher.

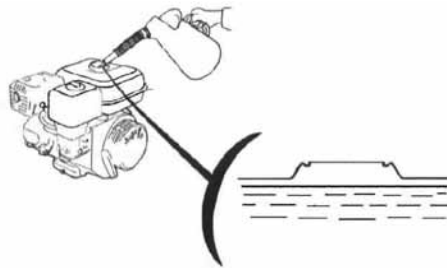

Gas Engine

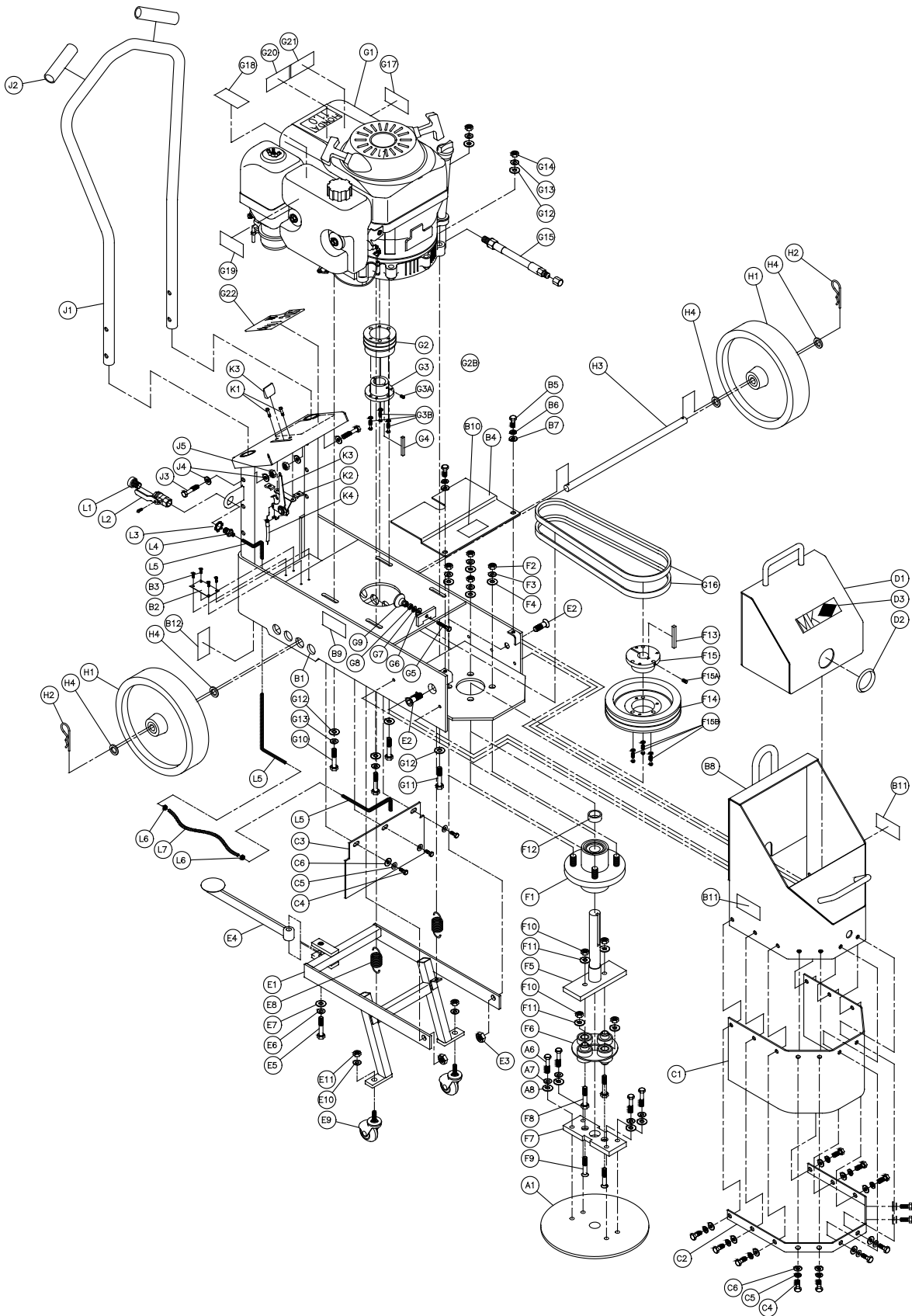

Gas Engine

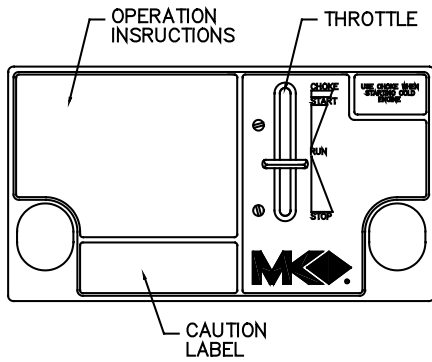

CONSOLE - GAS

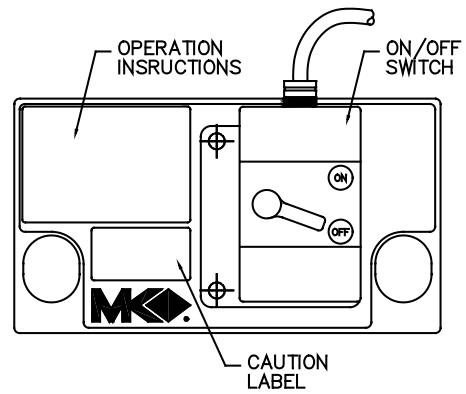

CONSOLE - ELECTRIC

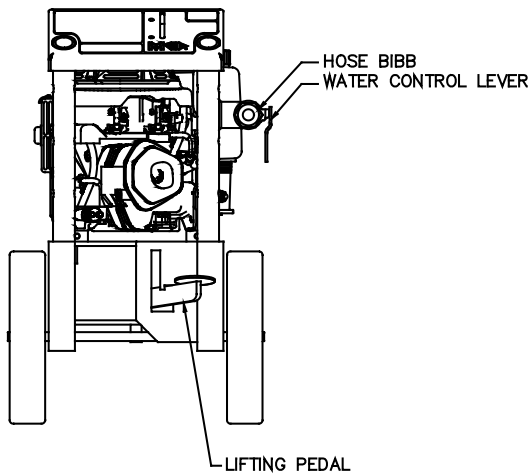

BACK SIDE

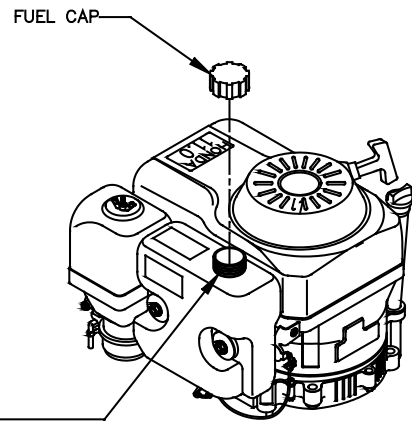

FUEL TANK

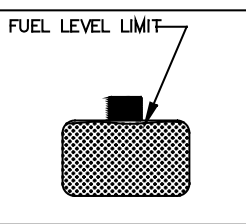
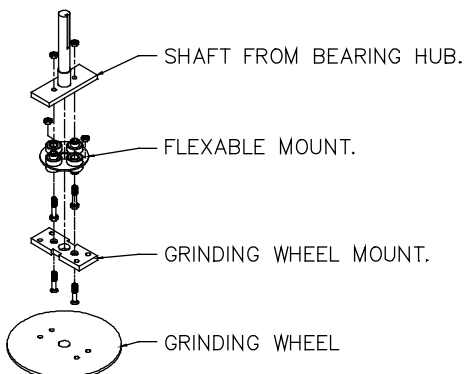

Electric Engine

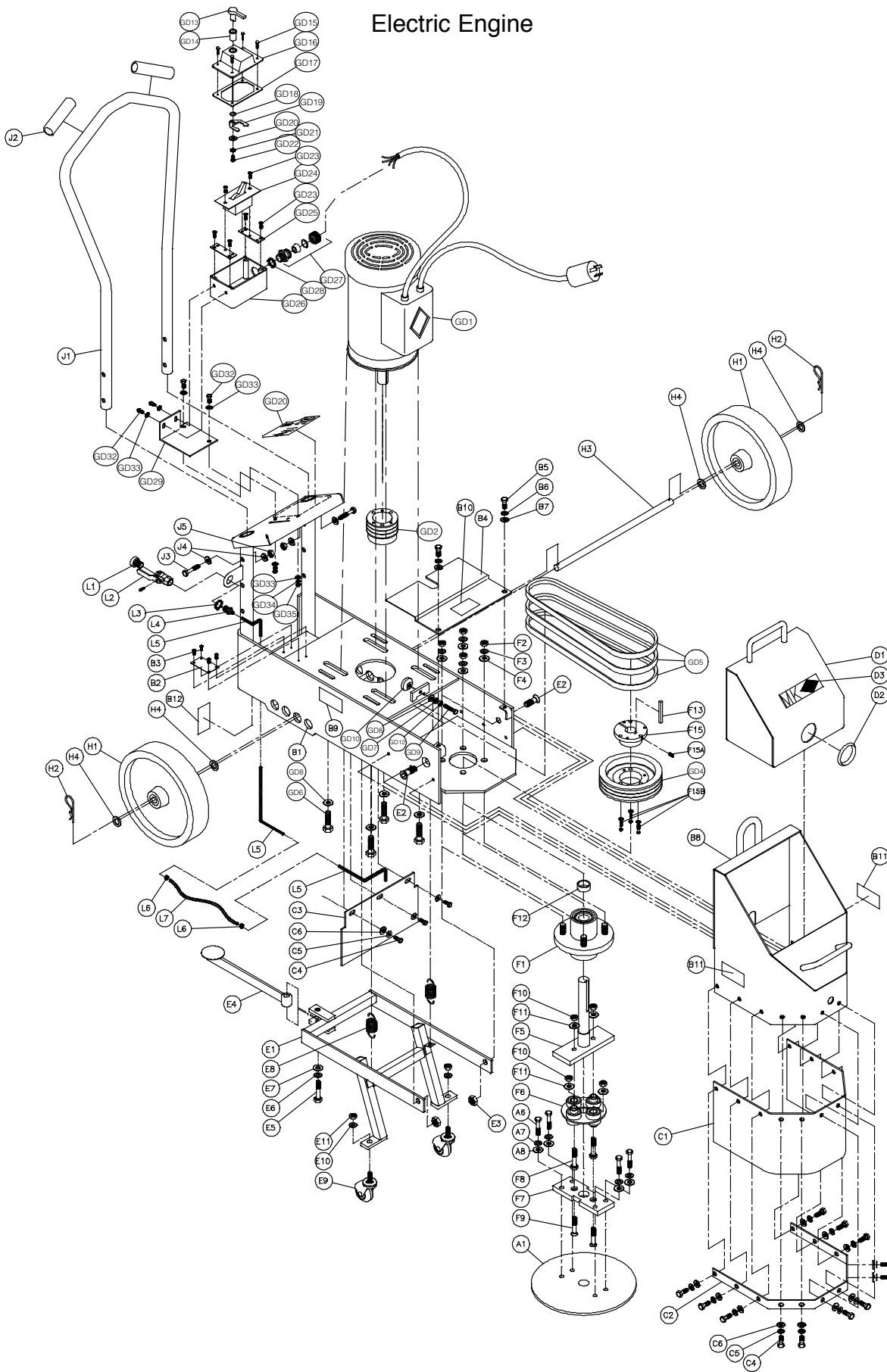

Item	Description	Qty	Part No.
A	Assembly, Accessory Pack		
A1	Grinding Wheels 10" (Reference only)	0	Reference
A2	Pallet (not shown)	1	158259
A3	Carton, SDG-11 Grinder (not shown)	1	158272
A4	Tube, Owner's Manual (not shown)	1	155419
A5	Manual, Owner's (not shown)	1	158273
A6	Bolt, Hex HD, 3/8-24 x 1 Grinding Disk, Mounting	4	157803
A7	Washer, 3/8 Split Lock	4	150925
A8	Washer, 3/8 SAE Flat	4	150923
B	Assembly, Frame		
B1	Frame Weldment	1	157780
B2	Plate, Serial Number	1	157500
B3	#7 X 5/16 Drive Screw	2	157849
B4	Tray, Weight	1	157785
B5	Screw, 5/16-18 x 3/4 Hex Head	2	151369
B6	Washer, 5/16 lock, split	2	151747
B7	Washer, 5/16 SAE Flat	2	151754
B8	Housing, Weight	1	157783
B9	Label, Caution, Belt Tension	2	155583
B10	Label, Caution, Guards in Place	1	155587
B11	Label, Caution, Hands and Feet	2	155585
B12	Label, Lower/Raise	1	158141
C	Assembly, Skirt		
C1	Skirt, Front	1	157817
C2	Skirt, Retainer	1	157819
C3	Skirt, Rear	1	157818
C4	Screw, 5/16-18 x 3/4 Hex Head	15	151369
C5	Washer, 5/16 lock, split	15	151747
C6	Washer, 5/16 SAE Flat	15	151754
D	Assembly, Weight Box		
D1	Box, Weight	1	157784
D2	Cap, Weight Box	1	157890
D3	Label, 1 3/4 x 5" MK Logo	1	154335
E	Assembly, Lifting Frame		
E1	Frame, Lifting	1	157781
E2	Screw, Flat HD SOC. 1/2-13 x 1"	2	157822
E3	Nut, Center Lock 1/2-13	2	153943
E4	Pedal, Lifting Frame	1	157782
E5	Bolt, 1/2-13 x 2 Hex Head	1	153533
E6	Washer, Lock, Split 1/2	1	153524
E7	Washer, Flat SAE 1/2	1	150924
E8	Spring, Lifting Frame	2	157821
E9	Wheel, 2" Caster (LA-E2-XD)	2	160455
E10	Washer, 5/16 lock, split	2	151747
E11	Nut, 5/16-18 Hex	2	101196
F	Assembly, Components, Hub		
F1	Hub, 1" Assembly (3 1/2 C)	1	157820
F2	Nut, Jam 1/2-20	4	154460

F3	Washer, Lock, Split 1/2	4	153524
F4	Washer, Flat SAE 1/2	4	150924
F5	Shaft, 1" Dia Large Gear	1	157302
F6	Flexible Mount, Morflex (Morse 402 Insert)	1	157411
F7	Mount, Grinding Wheel	1	157407
F8	Screw, Hex HD Cap 3/8-16 x 2 1/2	2	156030
F9	Screw, Flt. HD. Sc. 3/8-16 x 2 1/2	2	157562
F10	Nut, 3/8-16, Hex Nylock	4	152505
F11	Washer, 3/8 SAE Flat	4	150923
F12	Spacer, 1 1/4" OD, 1" I.D. x 1 3/8"	1	158257
F13	Key, Square, 1/4 x 1/4 x 1 1/2"	1	157560
F14	Pulley, 2G3V 6.9 SDS	1	160098
F15	QD x 1" SD (D1 reverse mount sheave bushing)	1	157899
G	Assembly, Engine, 11HP Honda		
G1	Engine, Honda GX340k2dx3	1	157067
G2	Pulley, 2G3V 2.20 JA	1	160099
G3	QD x 1" SH (sheave bushing)	1	157900
G4	Key, Square, 1/4 x 1/4 x 1 1/2"	1	157560
G5	Screw, 3/8-16 x 1 3/4" Hex Head Tap	1	158398
G6	Washer, 3/8 SAE Flat	1	150923
G7	Washer, 3/8 Split Lock	1	150925
G8	Nut, 3/8-16 Hex	1	101188
G9	Mount, 3/8-16 Swivel	1	158371
G10	Screw, 5/16-24 x 1" Hex Head	2	157646
G11	Screw, 5/16-18 x 1 3/4" Hex Head Cap	2	150919
G12	Washer, 5/16 SAE Flat	4	101352
G13	Washer, 5/16 Split Lock	4	151747
G14	Nut, 5/16-18 Hex	2	101196
G15	Hose, Oil Drain (20mm)	1	157577-04
G16	Belt, 3VX 375	2	157891
G17	Label, Caution, Hot Surface, 1.5 x 3.0	1	155578
G18	Label, Warning, Refueling, 1.5 x 3.0	1	155580
G19	Label, Danger, California, 1.5 x 3.0	1	155581
G20	Label, Danger, Lethal Exhaust, 1.5 x 3.0	1	155582
G21	Label, Caution, Sparkplug	1	155579
G22	Label, Control Panel (Gas)	1	157888
GB	Assembly, 115/230V, 3Hp Motor		
GD1	Motor, 3Hp 208-230V 60Hz 1725rpm	1	161179
GD2	Pulley, 3V/3V27 x 1-1/8 Bore	1	160625
GD3	Screw, Set, Cup Pt, 1/4-20 x 5/16	1	154226
GD4	Pulley, 3/3V50 x SDSQD	1	160193
GD5	Belt, 3VX355	3	160385
GD6	Screw, Hex Hd, 1/2-13 x 1-1/4	4	153532
GD7	Washer, Lock, Split, 1/2	4	153524
GD8	Washer, Flat, SAE, 1/2	4	150924
GD9	Screw, Hex Hd. Tap, 3/8-16 x 1-3/4	1	158398
GD10	Mount, 3/8-16 Swivel	1	158371
GD11	Pulley, 3/3V50 x SDSQD	1	160193
GD12	Nut, Hex, 1/2-13	4	151282
GD13	Lever, Actuator	1	159540
GD14	Bushing, Switch 30A	1	158799
GD15	Screw, Pan Hd, #6-32 x 5/8	4	157393
GD16	Cover, Switch Box, 30A	1	159539

GD17	Gasket, 30A Switch Box	1	159491
GD18	Seal, Level, 30A Switch Box	1	159492
GD19	Lever, On/Off, 30A Switch Box	1	159490
GD20	Washer, #10 SAE Flat	1	154369
GD21	Washer, Lock, IT, #10	1	158336
GD22	Screw, Pan Head #10-24 x 5/16	1	159494
GD23	Screw, Flat Head 6-32 X 5/16	6	159493
GD24	Switch, 30Amp Motor Controller	1	159488
GD25	Plate, Mounting, Switch	1	159489
GD26	Box, 30A Switch	1	159487
GD27	Connector, Cord LTF29	1	160689
GD28	Nut, MCFL, 1/2NPT	1	152729
GD29	Bracket, MK 212 Switch	1	159864
GD30	Screw, Pan Head Phillips 1/4-20 x 1/2	2	155452
GD31	Washer, Lock, Split, 1/4	2	152591
GD32	Screw, Hex Head Cap 5/16-18 x 3/4	2	151369
GD33	Washer, 5/16 Flat SAE	4	151754
GD34	Washer, 5/16 Split Lock	2	151747
GD35	Nut, 5/16-18 Hex	2	101196
GD36	Label, Control Panel, SDG Elect	1	160046
H	Assembly, Axle		
H1	Wheel, 10"Dia. x 2.5"	2	157889
H2	Cotter Pin, Steel Hairpin, 5/8" - 3/4" x .148" x 2 11/16"	2	158228
H3	Axle, 5/8" Dia.	1	157887
H4	Washer, 5/8 SAE Flat	4	158350
J	Assembly, Handlebar		
J1	Handlebar	1	157786
J2	Handgrip, .875 x 4.25 Neoprene	2	229413
J3	Screw, 3/8-16 X 2 Hex Head Cap	2	153485
J4	Washer, 3/8 SAE Flat	4	150923
J5	Nut, 3/8-16 Nylock Hex	2	152505
K	Assembly, Throttle, Honda		
K1	Screw, 10-24 X 1/2" Pan Head Phillips Cap	2	151744
K2	Nut, 10-24 Clip	2	155407
K3	Assembly, Throttle Head	1	155406
K4	Cable, Throttle, Honda	1	156640
L	Assembly, Water Valve		
L1	Fitting, Brass, 1/2 MNPT x Garden Hose Swivel	1	151322
L2	Valve, Shut-Off, 1/2 FNPT x 1/2 FNPT	1	150843
L3	Nut, 1/2 NPT	1	152729
L4	Fitting, Brass, 1/2 MNPT x 1/4 Compression Fit	1	157563
L5	Tube, 1/4 OD Water	2'	157564
L6	Clamp, 5/8 Hose	2	151198
L7	Hose, Water Vinyl 1/4 x 3/8	6'	132951

MK-1010/MK-1020 SERIES of grinding heads are designed to give rough concrete surfaces the smoothest finish in the quickest time. Available in either 10 or 20 segment configurations. Hard bond is for grinding green concrete and asphalt. Soft bond is for grinding cured concrete.



MK-1010H Premium Hard Bond Grinding Head

Diameter	Mount	Segments	Part#
10" (254 mm)	4 Bolt	10	158181

Segment Height: 8 mm

MK-1010S Premium Soft Bond Grinding Head

Diameter	Mount	Segments	Part#
10" (254 mm)	4 Bolt	10	151925

Segment Height: 8 mm



MK-1020H Premium Hard Bond Grinding Head

Diameter	Mount	Segments	Part#
10" (254 mm)	4 Bolt	20	158182

Segment Height: 8 mm

MK-1020S Premium Soft Bond Grinding Head

Diameter	Mount	Segments	Part#
10" (254 mm)	4 Bolt	20	151926

Segment Height: 8 mm



MK-1020 TURBO Supreme Hard Bond Grinding Head

Diameter	Mount	Segments	Part#
10" (254 mm)	4 Bolt	20	167939

Includes the mounting bolts



MK-1020 ARROW Supreme Soft Bond Grinding Head

Diameter	Mount	Segments	Part#
10" (254 mm)	4 Bolt	20	168446

Segment Height: 8 mm
Includes the mounting bolts

ORDERING INFORMATION

You may order MK Diamond products through your local MK Diamond distributor or, you may order direct from MK Diamond.

When ordering direct from MK Diamond, please have the following information ready before calling:

- The Model Number of the saw
- The Serial Number of the saw
- Where the saw was purchased and when
- The Part Number for the part(s) being ordered
- The Part Description for the part(s) being ordered

NOTE: There is a \$25.00 minimum order when ordering direct from MK Diamond. A \$5.00 charge will be added to orders having a net billing value under \$50.00. All purchases must be made using VISA, MasterCard or American Express.

All parts may be ordered by calling toll free to – 800 421-5830 or 310 539-5221 and asking for Customer Service. For technical questions, call – 800 474-5594.

RETURN MATERIALS POLICY

To expedite the service relative to the return of a product purchased through MK Diamond, please observe the following:

NOTE: When returning all items, they must have been purchased within the previous twelve (12) months.

- Have the Model Number of the saw
- Have the Serial Number of the saw
- Have the location of where the saw was purchased
- Have the date when the saw was purchased
- Contact Customer Service for approval to return the item(s)
- Obtain a Returned Goods Number (RGA) authorizing the return
- Follow the packaging instructions in the following section
- Ensure your item(s) are prepaid to the destination

For returned items, call toll free to – 800 421-5830 or 310 539-5221 and ask for Customer Service. For technical questions, call – 800 474-5594 or 310 257-2845.

PACKAGING INSTRUCTIONS

- Remove the Cutting Head and Support Angle Assembly
- Dry the saw before shipping
- When packing, include the following: Saw, Diamond Blade, Blade Guard and Support Angle Assembly and Adjustable Cutting Guide (Other Accessories are not required)
- Package the unit in its original container or one of comparable size (do not ship the unit partially exposed)
- Ensure all parts are secured in the packaging to prevent moving

AUTHORIZED SERVICE CENTERS

For quicker repair time, you may contact MK Diamond Customer Service, toll free, at 800 421-5830 or 310 539-5221 for the Authorized Service Center closest to you or visit our web site at www.mkdiamond.com. For technical questions, call – 800 474-5594.

CONTACT:

Please contact MK Diamond Products, Inc. Customer Service Department with any questions you might have regarding distributors, parts or service.

Telephone: **(800) 421-5830**

Fax: **(310) 539-5158**

E-mail: **Customer_Service@MKDiamond.com**

Customer Service Hours: **Monday through Friday, 6AM-4PM PST**

MK Diamond Products, Inc.

1315 Storm Parkway

Torrance, CA 90501

MK DIAMOND PRODUCTS, INC. LIMITED WARRANTY

MK DIAMOND PRODUCTS, INC. will guarantee every machine they build, to be free from defects in material and workmanship for (1) one year from date of purchase. The obligation of MK DIAMOND PRODUCTS, INC. under this warranty is limited to the repair or replacement of any parts which, under normal use, prove to be defective in material or workmanship. The parts involved or the unit in question should be returned to MK DIAMOND PRODUCTS, INC. or to a point designated by us, transportation prepaid.

This warranty does not obligate us to bear the cost of labor or transportation charges in connection with replacement or repair of defective parts. Likewise, it shall NOT apply to any unit which has been subjected to misuse, neglect or accident. This warranty does NOT apply to any machine which has been repaired or altered outside our factory.

This warranty does NOT obligate MK DIAMOND PRODUCTS, INC., with respect to items not of our manufacture, such as engines, motors, hydraulics, etc., which are subject to their own guarantees and warranties.

We shall in no event be liable for consequential damages or contingent liabilities arising out of failure of any equipment or parts to operate properly.

© COPYRIGHT 2011, MK DIAMOND PRODUCTS, INC. ALL RIGHTS RESERVED.

The MK Diamond logo is a registered trademark of MK Diamond Products, Inc. and may not be used, reproduced, or altered without written permission. All other trademarks are the property of their respective owners and used with permission.

MK Diamond may have patents, patent applications, trade marks, copyrights of other intellectual property right covering this product in this document.

This manual MUST accompany the equipment at all times. This manual is considered a permanent part of the equipment and should remain with the unit if resold.

The information and specifications included in this publication were in effect at the time of approval for printing.

MK- SINGLE DISC GRINDER
OWNERS MANUAL, PARTS LIST &
OPERATING INSTRUCTIONS



MK Diamond Products, Inc.

MK Diamond Products, Inc.
1315 Storm Parkway
Torrance, CA 90501

Toll-Free: (800) 421-5830
Phone: (310) 539-5221
Fax: (310) 539-5158
www.mkdiamond.com