

SurPro®

Scan QR code
for the latest
Instruction Manual



SII / SIX

DOUBLE-SIDED STILTS

INSTRUCTION MANUAL

VERSION 21.08

APPLIES TO:

SurPro S2 Aluminum Drywall Stilts

SurPro S2 Magnesium Drywall Stilts

SurPro S2X Magnesium Drywall Stilts
(Illustrated to right)

Proper reading and understanding this instruction manual is required before operating SurPro S2/S2X stilts. Following this guide is the first step towards proper safety, assembly, operation and maintenance.

PROPER ASSEMBLY REQUIRED.



STILTS.com

**Need Help?
1-888-443-8889**

WELCOME

Thank you for choosing SurPro and Stilts.com. This instruction manual will help navigate the safety, assembly, and maintenance of the SurPro S2, and S2X Double-Sided Stilts. Please find an alternative instruction manual if your model is not listed on the cover. Keep this manual available for all users; Reading and understanding of all contents is required before authorized user of the stilts. Contact The Forest Group or your local distributor for any questions as well as for replacement parts or warning stickers/graphics for the stilts.

NOTICE

INTENDED USE: CONSTRUCTION TRADES ONLY

SurPro Stilts are professional grade stilts intended and manufactured for commercial use in the construction trades (drywall, insulation, electrical, paint, etc.) only. The stilts covered in this instruction manual are **NOT** to be used for recreation, as a performance prop, or by children. Unintended use is prohibited.

NOTICE

ALWAYS PERFORM A SAFETY INSPECTION

Before each use, ensure stilts are assembled properly, inspect all components for damage (and replace parts when needed), ensure all connections are safe and secure. Stilts require regular maintenance as parts and components wear over time. Use only proper Genuine SurPro parts and spare part kits when needed.

NOTICE

READ, UNDERSTAND AND FOLLOW

Read the manual and follow safety guidelines completely. Understand that SurPro, Stilts.com, The Forest Group, Inc. and dealers of SurPro products are not responsible for incidences resulting from negligence, unintended or improper use, failure due to lack of maintenance, use of improper parts, or use of non-genuine SurPro parts.

NOTICE

LEARN TO WALK SAFELY ON STILTS

New users must learn and demonstrate safe, proper stilt walking techniques. All users must read the "Learning to Walk" section of this manual on page 10. Never supply a new user with stilts without proper training.

WARNING: DO NOT EXCEED load limit of 225 LB

User weight (including tools, clothing, boots, safety equipment, and materials being handled) should not exceed 225 LB.

TABLE OF CONTENTS

NOTICE	2
WARNING & SAFETY PRECAUTIONS	4
APPLICABLE MODELS	5
PACKAGE CONTENTS (S2 & S2X)	6-7
ASSEMBLY INSTRUCTIONS	8-10
STILT ADJUSTMENTS	10-12
LEARNING TO WALK	12
GENUINE PARTS & PARTS DIAGRAMS	13-15
PART KITS	15
PARTS LIST	16-17
CARE & MAINTENANCE	18



PRODUCT REGISTRATION & WARRANTY

First things first, register your SurPro stilts for the best in customer care, service, and warranty. Do it online! It's quick and easy. www.stilts.com/product-registration



PG. 19

WARNING & SAFETY PRECAUTIONS



Under no circumstances should the stilts be used while under the influence of alcohol, drugs, or other medications that can impair your balance, judgment, or cause drowsiness. Do not over-reach while on stilts. Do not exceed max load limit (225 LB). Do not operate without proper safety, operation and maintenance knowledge. Always keep your stilts planted firmly on solid ground.

Always inspect your walking area. Perform a jobsite inspection to be sure the area is free of tripping hazards including, but not limited to: extension cords, drop cloths, spilled liquids, debris or obstacles. Your worksite should not have any open stairwells, vents, or windows that would present a fall or tripping hazard. Never use your stilts on scaffolding or on plywood that is placed over any type of opening. Only use stilts on solid, firm and stable ground.

Always inspect your stilts prior to every use. Check for worn or damaged parts and always replace with Genuine SurPro parts. Check and tighten all nuts and bolts, but do not over-tighten any loose nuts, wing bolts or screws. SurPro, Stilts.com and The Forest Group, Inc. are not responsible for any equipment failures if non-genuine SurPro parts are used, or stilts are not maintained.

Clean your stilts regularly. Dirty equipment may obscure excessive wear. Keep soles and surrounding area clean, dry, and free of lubricants, debris, and obstacles which may cause slipping or tripping.

Keep lubricated. Keep all pivot points and adjustment joints clean and lubricated. Lubricate lightly, when necessary, with silicone or graphite-based lubricants.

Mount and dismount your stilts with the help of a spotter using a clean and level area away from doors, windows, stairwells, floor vents, etc. Never jump on or off stilts. Step down using a work platform of the appropriate height.

APPLICABLE MODELS

This manual covers SurPro Double-Sided Stilts (Models S2 & S2X).

Package contents and assembly instructions will be the same unless otherwise noted.



ALUMINUM

MODEL NO. **DESCRIPTION**

S2-A-1624 SurPro S2 Aluminum Drywall Stilts, 16"-24"

S2-A-2030 SurPro S2 Aluminum Drywall Stilts, 20"-30"

S2-A-2640 SurPro S2 Aluminum Drywall Stilts, 26"-40"

See Page 6 for S2 Package Contents



MAGNESIUM

MODEL NO. **DESCRIPTION**

S2-M-1624 SurPro S2 Magnesium Drywall Stilts, 16"-24"

S2-M-2030 SurPro S2 Magnesium Drywall Stilts, 20"-30"

S2-M-2640 SurPro S2 Magnesium Drywall Stilts, 26"-40"

See Page 6 for S2 Package Contents

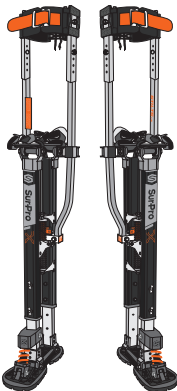

MAGNESIUM

MODEL NO. **DESCRIPTION**

S2X-M-2030 SurPro S2X Magnesium Drywall Stilts, 20"-30"

S2X-M-2640 SurPro S2X Magnesium Drywall Stilts, 26"-40"

See Page 7 for S2X Package Contents

S2 PACKAGE CONTENTS

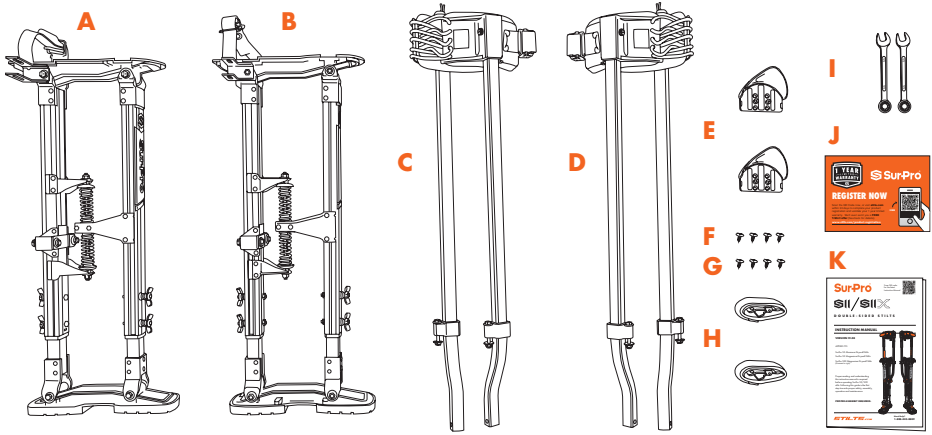

Do you have **S2X** Stilts? See **PG. 7**

WHAT'S IN THE BOX

Congratulations on your purchase of SurPro S2 Stilts. Please inspect the contents of this box immediately. Your S2 model stilts should arrive with the following components:

A	1	Right Main Body Stilt w/ Arch Strap (Must secure Arch Strap w/ 2 Screws)
B	1	Left Main Body Stilt w/ Arch Strap (Must secure Arch Strap w/ 2 Screws)
C	1	Right Leg Band w/ Side Poles, Side Pole Holders, and Hardware (Bolts, Washers and Nuts)
D	1	Left Leg Band w/ Side Poles, Side Pole Holders, and Hardware (Bolts, Washers and Nuts)
E	2	Heel Cups w/ Hardware (2 Bolts & 2 Nuts per Heel Cup)
F	4	Arch Strap Panhead Screws (2 for each Arch Strap - mounted under Foot Plate)
G	4	Toe Strap Panhead Screws (2 for each Toe Strap)
H	2	Toe Straps w/ Buckles
I	2	11mm Wrenches
J	1	Instruction Manual
K	1	Warranty Registration Card

Please ensure that all package contents are present before assembling Stilts. **DO NOT** walk on Stilts if parts are missing. Contact your supplier, or us, immediately if parts are missing.

S2X PACKAGE CONTENTS

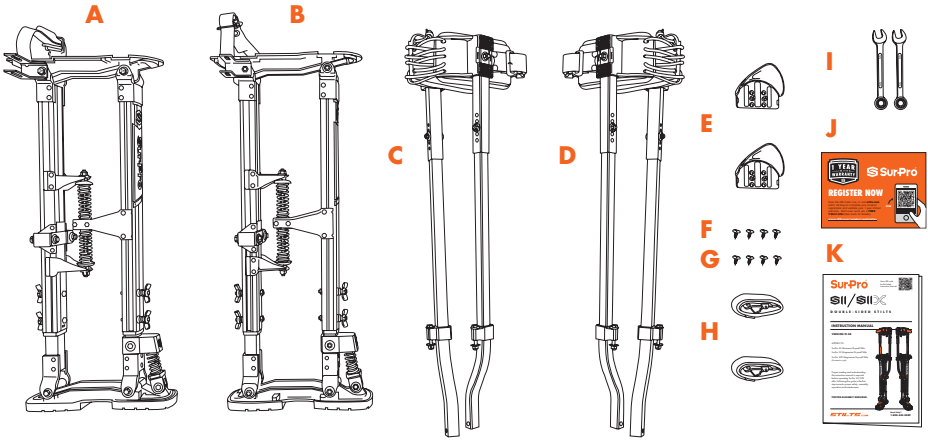

Do you have **S2** Stilts? See **PG. 6**



WHAT'S IN THE BOX

Congratulations on your purchase of SurPro S2X Stilts. Please inspect the contents of this box immediately. Your S2X model stilts should arrive with the following components:

A	1	Right Main Body Stilt w/ Arch Strap (Must secure Arch Strap w/ 2 Screws)
B	1	Left Main Body Stilt w/ Arch Strap (Must secure Arch Strap w/ 2 Screws)
C	1	Right Leg Band w/ Adjustable Side Poles, and Hardware (Bolts, Washers and Nuts)
D	1	Left Leg Band w/ Adjustable Side Poles, and Hardware (Bolts, Washers and Nuts)
E	2	Heel Cups w/ Hardware (2 Bolts & 2 Nuts per Heel Cup)
F	4	Arch Strap Panhead Screws (2 for each Arch Strap - mounted under Foot Plate)
G	4	Toe Strap Panhead Screws (2 for each Toe Strap)
H	2	Toe Straps w/ Buckles
I	2	11 mm Wrenches
J	1	Instruction Manual
K	1	Warranty Registration Card

Please ensure that all package contents are present before assembling Stilts. **DO NOT** walk on Stilts if parts are missing. Contact your supplier, or us, immediately if parts are missing.

ASSEMBLY INSTRUCTIONS

1 INSTALL HEEL CUP

Position the heel cup in one of the three mounting points depending on the size of the user's shoe. Secure heel bracket by inserting nuts onto the bottom of the foot plate. While holding the nuts down, insert screws through the top of the heel cup and secure to nuts.

Repeat this step for the other stilt.

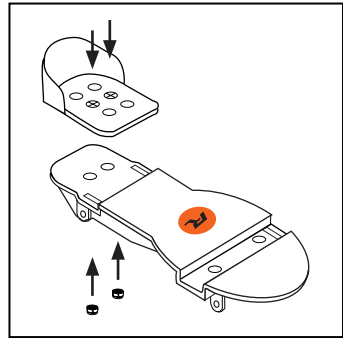

2 TOE & ARCH STRAPS POSITIONING

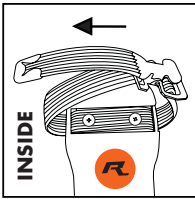

Toe straps must be threaded as depicted and mounted with panhead screws. Position buckle above the foot and oriented so that the strap can be tightened toward the inside.

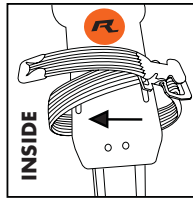

Arch straps can be mounted similar to the toe straps (on the top) - or as shown left - mounted below the foot plate toward the back of the heel. Straps tighten toward the inside of the foot plate.

Positioning and securing the Arch Straps below the Foot Plate

Place your foot on to the foot plate and rotate the arch strap into a comfortable position, where the strap can be tightened securely across the top of your foot/boot. Once you are happy with the positioning, secure the strap to the bottom of the floor plate with screws.

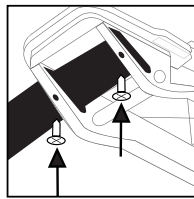
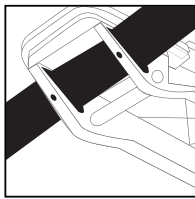
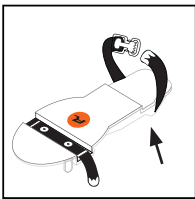

Repeat this step for the other stilt.

Always check your straps for excessive wear and replace when worn or frayed. Never wear or use worn out straps. Replacement straps and parts are available at stilts.com.

ASSEMBLY INSTRUCTIONS

Optional: Positioning and securing Arch Straps on top of the Foot Plate

Arch straps may also be worn directly below the heel, Use alternate mounting instructions as depicted below:

First remove, or loosen, the side pole clamp brackets to provide better access.

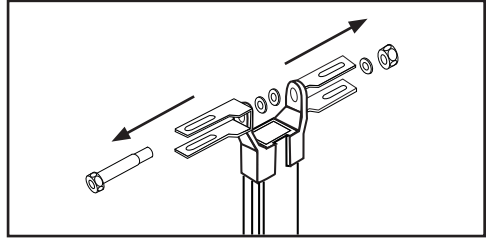

Then, thread the straps through the top portion of the footplate, and secure in place with panhead screws.

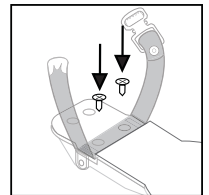
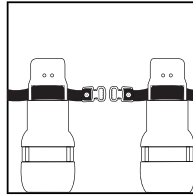

3 SIDE POLE INSTALLATION

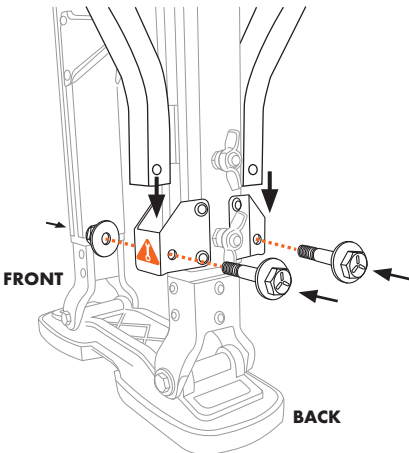

First, match Left and Right Leg Bands to Left and Right Stilt bodies. Insert Lower Strut Tubes into the two Outside Brackets on the main stilt body. Insert bolts with washers and attach nuts. Leave loose until side pole holders (item A on next page) are positioned into side pole bracket (item B on next page). Fasten poles securely using 11 mm wrenches before use.

Repeat this step for the other stilt.



Caution: Check the Outside Brackets before each use and ensure bolts and nuts are secure.

ASSEMBLY INSTRUCTIONS

SIDE POLE INSTALLATION CONTINUED.

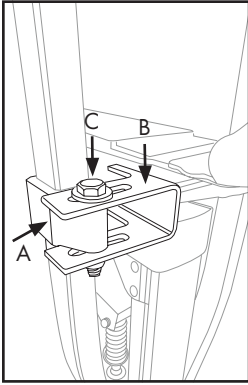

Position side pole holder (A) into side pole bracket (B) and secure with bolt, washer and nut (C). The side pole holder (A) is already attached to the side pole. Slide it into position between the side pole bracket (B). Adjust position depending on the width of your calf. You may need to loosen the laces on the back of leg band to widen the distance between the poles. If you do, be sure to tie a secure knot in the laces when finished. Once you determine the correct fitment (width), secure with 1¾" bolt, two washers and nylon locknut (C).

Repeat this step for the other stilt.

STILT ADJUSTMENTS

Tip: SurPro Stilts are designed to maximize the user's comfort and safety. SurPro Stilts have multiple points of adjustment to account for a variety of user preferences. Take some time to get them fitting and feeling just right. The time you spend adjusting things in the beginning will provide maximum performance and comfort on a daily basis.

1 STILT HEIGHT ADJUSTMENT

SurPro Stilts are designed to be used with 8 Wing Bolts (4 on each stilt). Using all Wing Bolts increases safety and also extends the lifespan of internal parts. The Double Wing Bolt design is an exclusive safety feature that also increases durability.

To adjust height:

Remove all Wing Bolts (HS142S), and slide the Inner Extension Tube to desired height.

Reinstall Wing Bolts and Hand-tighten at desired height.

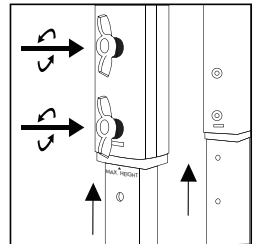
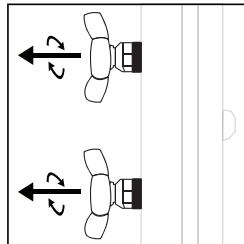

Caution: Do not pull the Inner Extension Tube past the "Max. Height" engraving, or force the Inner Extension Tube out of the Main Leg Strut. A plastic sleeve and tab is present to prevent this from happening, but excessive force will damage the plastic sleeve.

STILT ADJUSTMENTS

2 LEG BAND ADJUSTMENTS

Choose your Leg Band style below and follow specific instructions:

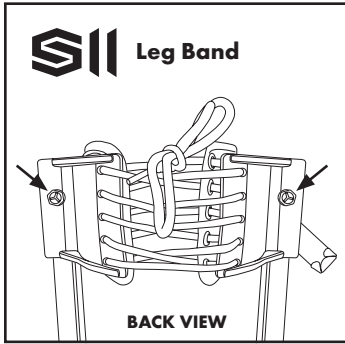

The S2 Leg Band can be raised and lowered if needed. Simply remove the bolts and slide the leg bands to align with additional holes in the side pole. These holes cannot be seen until bolts are removed and the Leg Band is repositioned. Secure bolts before use.

The laces can also be tightened or loosened to accurately and comfortably fit a variety of calf widths. Knot the laces tightly once desired fitment is achieved.

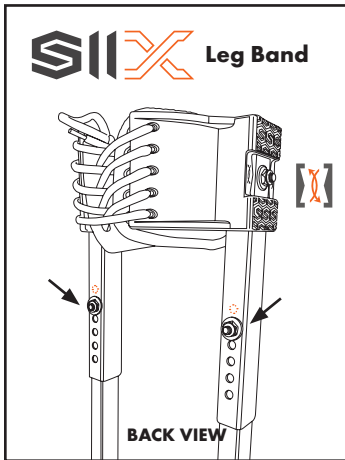

The S2X Rocking Leg Bands have 2-3/4" of height adjustment. Simply remove the bolts and align with additional holes in side poles. There are two holes on the inner side poles (holes that cannot be seen until bolts are removed - ). Use these holes to achieve maximum height. Secure bolts before use.



This icon represents the backward and forward rocking feature exclusive to these leg bands. These bolts **DO NOT** need to be removed for height adjustment.

The laces can also be tightened or loosened to accurately and comfortably fit a variety of calf widths. Knot the laces tightly once desired fitment is achieved.

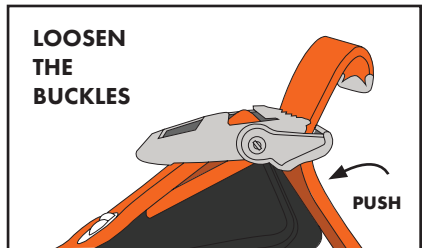
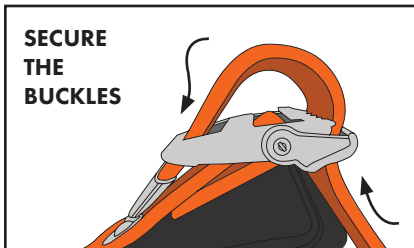

STILT ADJUSTMENTS

3 MAIN BODY SPRING TENSION

Note: The upper portion of the spring controls forward motion, whereas the lower portion of the spring controls backward motion.

To correct a tendency to lean forward, tighten the upper spring adjuster (A) to increase tension on the spring (clockwise rotation).

To correct a tendency to lean backwards when walking, tighten the lower spring adjuster (B) to increase tension on the spring (clockwise rotation).

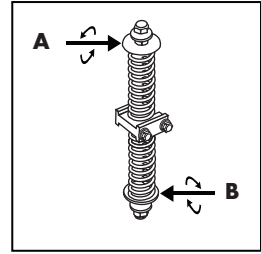

Caution: Always check that all bolts and screws have been tightened after making adjustments and prior to every use.

LEARNING TO WALK



WARNING: Always walk on a level, clean floor free of any tripping hazards. Avoid openings such as doorways, floor vents, stairwells, or windows that you can fall through. A messy jobsite is NOT the right place. Practice with a spotter and within reaching distance of a solid structure to hold to assist with balance.

WALKING INSTRUCTIONS & SAFETY TIPS

- Make sure all parts are installed and functioning properly and make the necessary adjustments to ensure a proper fit.
- Find a colleague/spotter to assist you with putting on the stilts and securing the straps. The spotter should also provide assistance to help you maintain your balance.
- Take slow, deliberate, and short steps. Lift your knees to pick up the stilts completely off the ground with each step. Never drag or shuffle your feet (stilts).
- Keep your legs spaced out enough that the stilts do not touch each other when walking.
- To change directions, walk in a wide "U" shaped pattern.
- Practice makes perfect, so take your time and ensure that you are comfortable and secure in the stilts before walking unassisted.
- **DO NOT** take large or over-extended steps, or reach and lean to the point where your balance is compromised.
- **NEVER** walk backwards on stilts, or up and down stairs.
- When walking sideways, look carefully before placing your stilts. Lift one foot at a time and carefully plant your foot on the floor before lifting the other foot.



ALWAYS USE GENUINE SURPRO PARTS



Inspect included parts carefully before use or installation. Look for wear or damage. If any component has been worn out, dented, cracked or bent, or if screws/washers/bolts/parts are missing or damaged, replace with genuine SurPro parts immediately.

Please note:

The Forest Group, Inc. is not responsible for any equipment failures if non-genuine SurPro replacement parts are installed or if the stilt is dismantled and components are not installed correctly.

PARTS DIAGRAMS

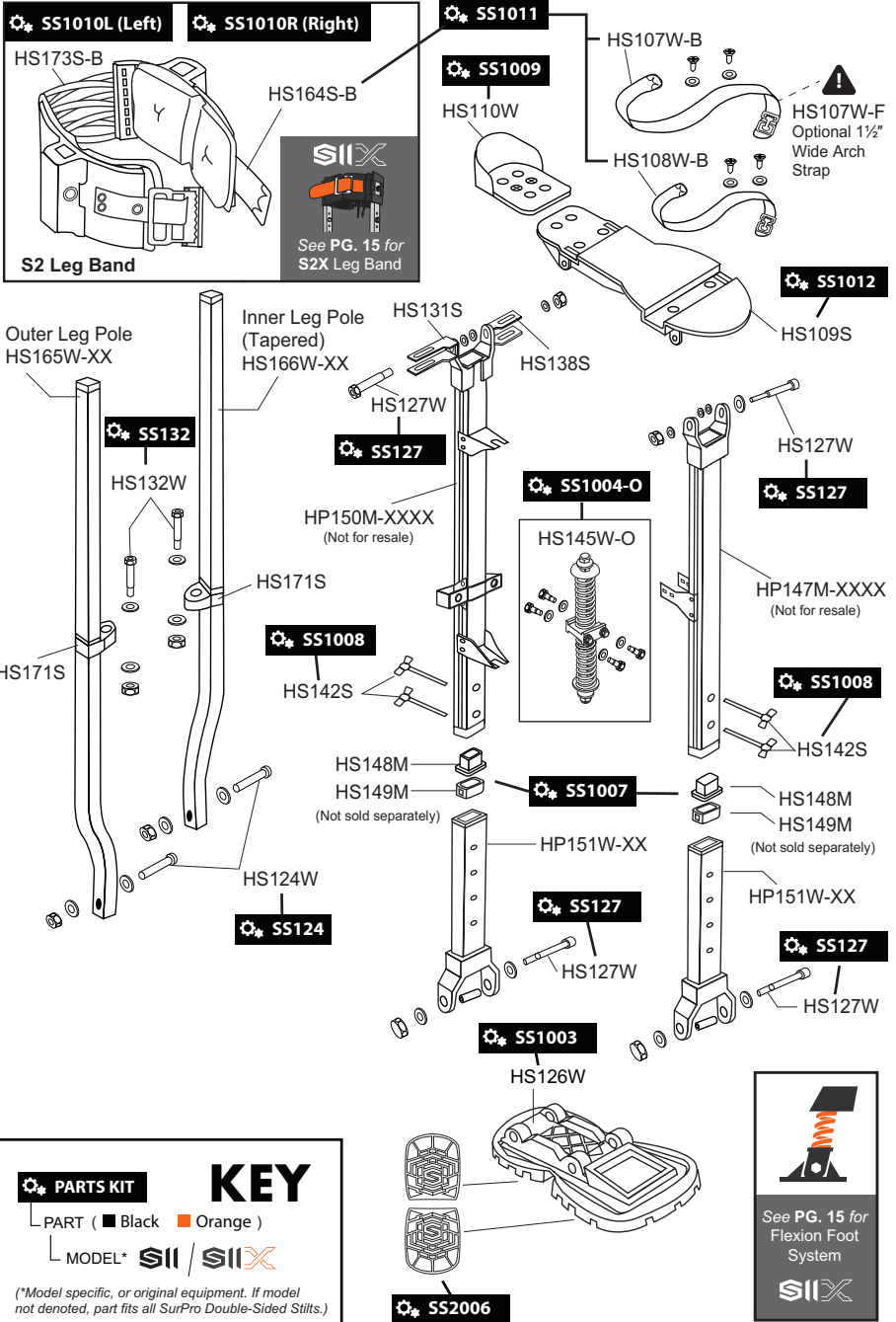

SIX Rocking Leg Band

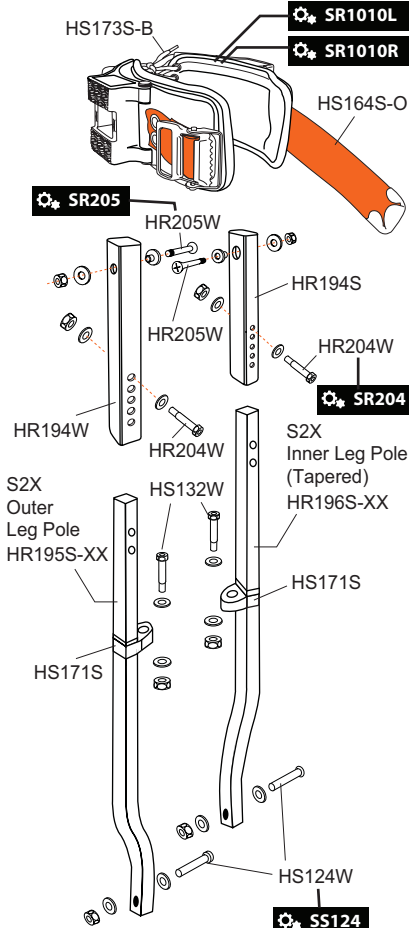

SIX Flexion Foot System

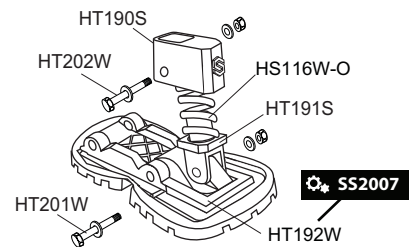

PART KITS

PART NO.	PART KITS DESCRIPTION
SS1003	Floor Plate Kit w/ Super Grip Soles (Pair).
SS1004-O	Main Body Spring Assembly Kit (Pair). (2) Springs w/ Hardware (HS145W-O).
SS1007	Nylon Sleeve Kit (Pair). (4) Nylon Sleeve Top (HS148M) and (4) Nylon Sleeve Bottom (HS149M).
SS1008	Wing Bolt Kit. (4) Wing Bolts w/ Washers (HS142S).
SS1009	Heel Bracket Kit w/ Screws (Pair). (2) Heel Brackets w/ (4) Screws (HS110W).
SS1010L	S2 Leg Band Kit (Left).
SS1010R	S2 Leg Band Kit (Right).
SR1010L	S2X Rocking Leg Band Kit (Left).
SR1010R	S2X Rocking Leg Band Kit (Right).
SS1011	Strap Kit, Black (Pair). (2) Leg Band Straps w/ Buckle (HS164S-B), (2) Arch Straps w/ Buckle, Screws and Washers (HS107W-B), (2) Toe Straps w/ Buckle, Screws and Washers (HS108W-B). *This kit includes Leg Bands w/ Black Straps, <u>not</u> w/ Orange Straps (HS164S-O).
SS1012	Foot Plate Kit (Pair).
SS2006	Super Grip Soles w/ Screws (4 soles). Fits all SurPro Stilt models.
SS2007	Flexion Floor Plate w/ Super Grip Soles (Pair). Fits S2X models only.
SS124	Side Pole Bolt Kit. (2) 1/4"-20 x 1-1/2" Cap Screws w/ (2) Locknuts and (4) Washers.
SS127	Main Strut Bolt Kit. (8) 1/4"-20 x 3" Cap Screws w/ Locknuts, Washers, and Spacers.
SS132	Side Pole Clamp Bolt Kit. (2) 1/4"-20 x 1-3/4" Cap Screws w/ Locknuts and (4) Washers.
SS134	Leg Band Bolt Kit. (4) 1/4"-20 x 2" Cap Screws, (4) Locknuts and (8) Washers.
SR204	Adjustable Double Side Pole Bolt Kit (1/4"-20 x 1-1/2" Cap Screw w/ Locknut and Washers) (4 Pack).
SR205	S2X Rocking Leg Band Bolt Kit w/ Nylon Bushing Kit (1/4"-20 x 1-1/2" Philips Head Screw w/ Locknut and Washer) (4 Pack).

See pages 16-17 for individual parts.

PARTS LIST

Part Kits fit all double-sided stilts (S2 & S2X) unless otherwise noted. Some are size specific.

PART NO.	PARTS DESCRIPTION
HS107W-B	Arch Strap w/ Accessories 1" W x 23" L
HS107W-F	Arch Strap (Wide) w/ Accessories 1.5" W x 23" L
HS108W-B	Toe Strap w/ Accessories 1.5" W x 17" L
HS109S	Nylon Foot Plate
HS110W	Adjustable Aluminum Heel Bracket w/ Screws
HS116W-O	Flexion Toe Spring with Bushing (Fits S2X)
HS124W	Side Pole Bolt Assembly (1/4"-20 x 1-1/2" Cap Screw w/ Locknut and Washers)
HS126W	Floor Plate with Super Grip Soles
HS127W	Main Strut Bolt Assembly (1/4"-20 x 3" Cap Screw w/ Locknut and Washers)
HS131S	Outer Metal Clamp Bracket
HS132W	Side Pole Clamp Bolt Assembly (1/4"-20 x 1-3/4" Cap Screw w/ Locknut and Washers)
HS134W	Leg Band Bolt Assembly (1/4"-20 x 2" Cap Screw w/ Locknut and Washers)
HS138S	Inner Metal Clamp Bracket
HS142S	Wing Bolt w/ Washer
HS145W-O	Spring Assembly
HS147M-16BM	Front Main Leg Strut - Magnesium / Black (Fits Size: 16"-24") <i>Not Sold Separately</i>
HS147M-16UA	Front Main Leg Strut - Aluminum / Silver (Fits Size: 16"-24") <i>Not Sold Separately</i>
HP147M-20BM	Front Main Leg Strut - Magnesium / Black (Fits Size: 20"-30") <i>Not Sold Separately</i>
HP147M-20UA	Front Main Leg Strut - Aluminum / Silver (Fits Size: 20"-30") <i>Not Sold Separately</i>
HP147M-26BM	Front Main Leg Strut - Magnesium / Black (Fits Size: 26"-40") <i>Not Sold Separately</i>
HP147M-26UA	Front Main Leg Strut - Aluminum / Silver (Fits Size: 26"-40") <i>Not Sold Separately</i>
HS148M	Nylon Sleeve (Top) <i>Sold in Kit</i>
HS149M	Nylon Sleeve (Bottom) <i>Sold in Kit</i>
HS150M-16BM	Back Main Leg Strut - Magnesium / Black (Fits Size: 16"-24") <i>Not Sold Separately</i>
HS150M-16UA	Back Main Leg Strut - Aluminum / Silver (Fits Size: 16"-24") <i>Not Sold Separately</i>
HP150M-20BM	Back Main Leg Strut - Magnesium / Black (Fits Size: 20"-30") <i>Not Sold Separately</i>
HP150M-20UA	Back Main Leg Strut - Aluminum / Silver (Fits Size: 20"-30") <i>Not Sold Separately</i>
HP150M-26BM	Back Main Leg Strut - Magnesium / Black (Fits Size: 26"-40") <i>Not Sold Separately</i>
HP150M-26UA	Back Main Leg Strut - Aluminum / Silver (Fits Size: 26"-40") <i>Not Sold Separately</i>
HP151W-16	Inner Extension Tube w/ Sleeves (Fits Size: 16"-24")
HP151W-20	Inner Extension Tube w/ Sleeves (Fits Size: 20"-30")
HP151W-26	Inner Extension Tube w/ Sleeves (Fits Size: 26"-40")

PARTS LIST

Part Kits fit all double-sided stilts (S2 & S2X) unless otherwise noted. Some are size specific.

PART NO.	PARTS DESCRIPTION
HT151W-20	Flexion Inner Extension Tube w/ Sleeves (Fits S2X, Size: 20"-30")
HT151W-26	Flexion Inner Extension Tube w/ Sleeves (Fits S2X, Size: 26"-40")
HS164S-B	Leg Band Strap - Black (Dimensions: 1-1/2" width, 11" length)
HS164S-O	Leg Band Strap - Orange (Dimensions: 1-1/2" width, 11" length)
HS165W-16	Square Double Side Outer Pole w/ Endcap and Holder (Fits: 16"-24")
HS165W-20	Square Double Side Outer Pole w/ Endcap and Holder (Fits: 20"-30")
HS165W-26	Square Double Side Outer Pole w/ Endcap and Holder (Fits: 26"-40")
HS166W-16	Square Double Side Inner Pole w/ Endcap and Holder (Fits: 16"-24")
HS166W-20	Square Double Side Inner Pole w/ Endcap and Holder (Fits: 20"-30")
HS166W-26	Square Double Side Inner Pole w/ Endcap and Holder (Fits: 26"-40")
HS171S	Side Pole Holder
HS173S-B	Leg Band Laces - Black (Each)
HT190S	Flexion Upper Spring Block (Fits: S2X)
HT191S	Flexion Spring Pivot (Fits: S2X)
HT192W	Flexion Floor Plate w/ Super Grip Soles (Fits: S2X)
HR194W	Square Double Sided Adjustable Upper Pole (Fits S2X, Size: 20"-30" & 26"-40")
HR195S-20	Square Double Sided Adjustable Inner Lower Pole (Fits S2X, Size: 20"-30")
HR195S-26	Square Double Sided Adjustable Inner Lower Pole (Fits S2X, Size: 26"-40")
HR196S-20	Square Double Sided Adjustable Outer Lower Pole (Fits S2X, Size: 20"-30")
HR196S-26	Square Double Sided Adjustable Outer Lower Pole (Fits S2X, Size: 26"-40")
HT201W	Flexion Spring Pivot Bolt w/ Locknut and Washers (Fits: S2X)
HT202W	Flexion Toe Spring Block Bolt w/ Locknut and Washers (Fits: S2X)
HR204W	Rocking Leg Band Bolt Assembly - 1/4"-20 x 1-1/2" Cap Screw w/ Locknut and Washer (Fits: S2X)
HR205W	Rocking Leg Band Bolt w/ Nylon Bushing - 1/4"-20 x 1-1/2" Philips Head Screw w/ Locknut and Washer (Fits: S2X).



NEED HELP LOCATING PARTS?

We are happy to help you locate the correct parts for your stilts or answer any questions.



+1 (888) 443-8889



help@stilts.com

PRODUCT REGISTRATION & WARRANTY



REGISTER YOUR STILTS!

We strongly encourage you to take a minute and register your new SurPro Stilts. Product registration is required for all warranty claims. Do it online, or hover your smart phone camera over the QR code below.

Register online

www.stilts.com/product-registration

Or

Scan QR

Code



1 YEAR LIMITED WARRANTY

The Forest Group, Inc. offers a one-year limited warranty on the structural components of your SurPro Stilts against manufacturing defects from the date of purchase. Excluded are components subject to normal wear, abuse, neglect, or improper assembly. Excluded wear parts include, but are not limited to, nylon bushings, sleeves, leg bands, soles, springs, and straps. The Forest Group, Inc. does not cover damage incurred by misuse of the product. In particular,

SurPro S2 and S2X Stilts are designed and intended for use in the construction and drywall industries and are not designed for use as recreational or performance prop. The Forest Group, Inc. is only responsible for the repair and replacement of SurPro products and parts. This warranty does not cover consequential damages, incidental damages, or damages to persons or property connected to the use of our products. The product owner is responsible for inbound shipping costs. Excluded from all warranties are inbound freight and postage for freight losses. The warranty is non-transferable and limited exclusively to the original purchaser.

All warranty returns for repair must include a Return Merchandise Authorization (RMA) number provided by us, and a copy of the original proof of purchase. Unauthorized returns without an RMA number, or proof of purchase, will not be accepted. To obtain an RMA number, please:

Submit a Warranty Service Form Online

www.stilts.com/warranty

Or

Call 1-888-443-8889



Need Help?



+1-888-443-8889



help@stilts.com



5600 Bonhomme Rd Ste C Houston, TX 77036

A division of The Forest Group, Inc.

STILTS.COM